



INSTRUCTIONS
360 Y-DROP[®]
SQUARE TUBE UPGRADE

APACHE

INSTRUCTIONS

360 Y-DROP

SQUARE TUBE UPGRADE

APACHE



Figure 1 Upgrade completed

⊕ RECOMMENDED TOOLS

- + Ratchet wrench with 1/2" and 9/16" deep well sockets
- + 3/8" 12-point socket
- + 1/2" and 9/16" combination wrenches

⊕ TORQUE VALUES

- + Refer to these torque values when tightening all fasteners

+ 5/16" stainless	U-bolt	15 ft/lbs
+ 5/16" stainless	Set screw	15 ft/lbs
+ 3/8" carbon	U-bolt	35 ft/lbs
+ 5/16" carbon	U-bolt	30 ft/lbs
+ 5/16" carbon	Stop bolt	30 ft/lbs

⊕ QUESTIONS

- + Call our Product Support team at 888-512-4890

I. REMOVE RISER TUBE ASSEMBLIES

Follow these steps to remove each riser tube assembly:

Figure 2

Step 1 Remove pin (1).

Step 2 Remove riser tube assembly (2).

Repeat Steps 1-2 for all riser tube assemblies.

Retain riser tube assemblies for later reinstallation.

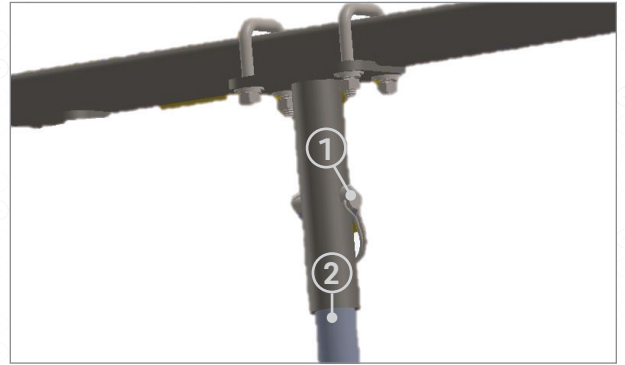

Figure 2

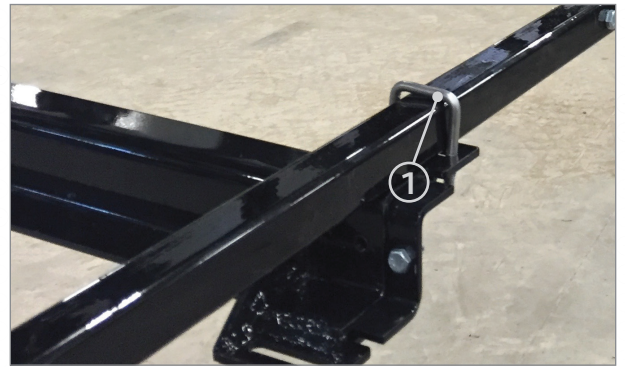

Figure 3

II. INSTALL MOUNT ASSEMBLIES ON THE OEM PRIMARY BOOM

NOTE: Replace one Z-bar assembly at a time. The square tube upgrade mount assemblies will be installed in the same location.

Figure 3

Step 1 Remove U-bolt (1).

Step 2 Remove pins (1) and yoke strap assembly (2). Repeat for remaining yoke strap assemblies.

NOTE: These yoke strap assemblies will not be used for the square tube upgrade and may be discarded.



CAUTION: The 360 Y-DROP system's boom assembly may weigh up to 60 pounds (27 kg). Exercise caution.

Step 3 Remove all of the 360 Y-DROP boom assemblies.

Repeat Steps 1-3 for the remaining 360 Y-DROP boom system.

Step 4 Remove all Z-bracket-related hardware from the primary booms.

II.

INSTALL MOUNT ASSEMBLIES ON THE OEM PRIMARY BOOM *(continued)*

Figure 4

Step 5 With the threads pointing down, install U-bolt (1) on the top of the OEM primary boom.

Bag AA

Step 6 Install bracket assembly (2) and flange lock nut (3).

Hardware Kit D

Step 7 Install extension tube (4).

Figure 5

Step 8 Install boom bracket (1) onto the extension tube.

Step 9 Install stop bolts (2) at both the front and the rear of the extension tube.

Hardware Kit B

Figure 6

Step 10 Install stainless steel set screw and jam nut assembly (1) onto the bracket assembly.

Hardware Kit D

Repeat Steps 1-10 for the remaining mount assemblies on the OEM primary boom.

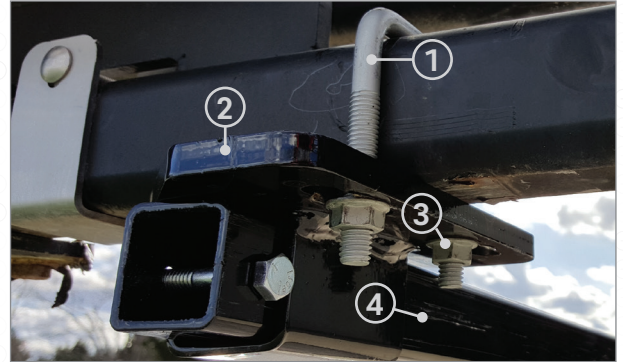

Figure 4



Figure 5



Figure 6

II.

**INSTALL MOUNT ASSEMBLIES
ON THE OEM PRIMARY BOOM** *(continued)*

Figure 7

- Step 11** With the U-bolt pointing to the rear, install the yoke mount (1) and flange nuts to upper boom section.
- Step 12** With the square U-bolt threads pointing up and using the extra thick washer and Nylock nut, install yoke mount (2) to the 360 Y-DROP boom section.
- Step 13** Using pins, install the yoke straps (3) between the upper boom and 360 Y-DROP boom. Using the flange nuts, tighten the 1-1/4" carriage bolts.

Repeat Steps 11-13 for the remaining yokes on the OEM primary booms. Yokes should be spaced approximately 60" (± 5 ") apart.



Figure 7

III.

INSTALL CENTER SECTION
SQUARE TUBE UPGRADE

In preparation for this process, first remove all Z-bracket-related hardware from the center section.

Figure 8

Step 1 Place 8" top plate (1) on top of the center section and install two 7.5" bolts (2) with 3/8" washers and carriage bolts (3). Note the carriage bolt at the rear of the boom will need to be set in place on the 14" top plate before it is installed in Step 2.

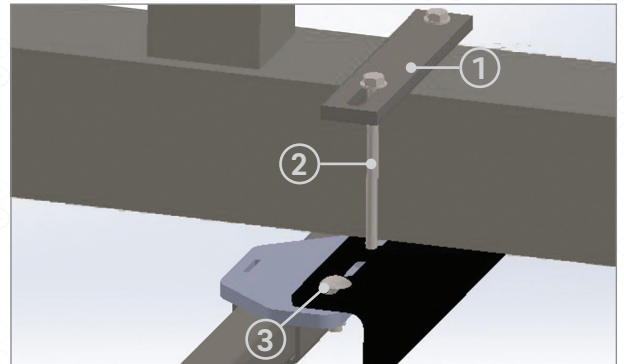

Figure 8

Figure 9

Step 2 Place 14" top plate (1) and bracket assemblies (2) into position, then install four 3/8" flange nuts (3).

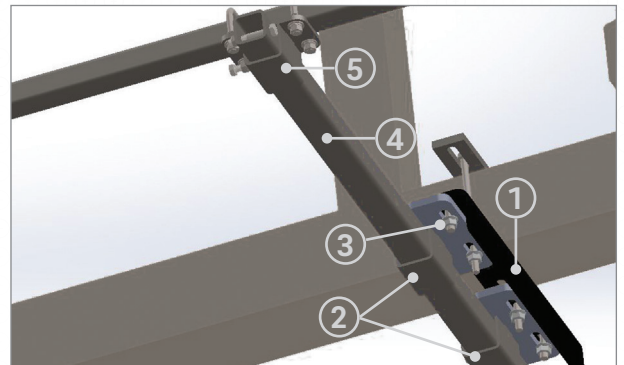

Figure 9

Step 3 Install extension tube (4) onto bracket assembly (2).

Step 4 Install boom bracket (5).

Figure 10

Step 5 Install stainless steel set screw and jam nut assembly (1).

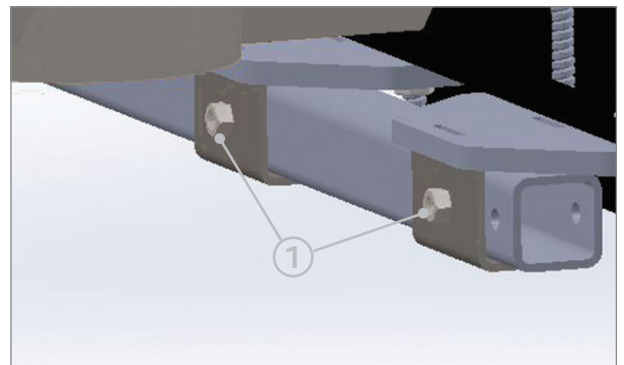

Figure 10

Figure 11

Step 6 Install square U-bolt (1), the 5/16" extra thick washers and the 5/16" nuts.

Hardware Kit A

Step 7 Reinstall 360 Y-DROP boom assembly (2).

Step 8 Install stop bolts (3) at both the front and the rear of the extension tube.

Hardware Kit B

Step 9 Install stainless steel set screw and jam nut assembly (4).

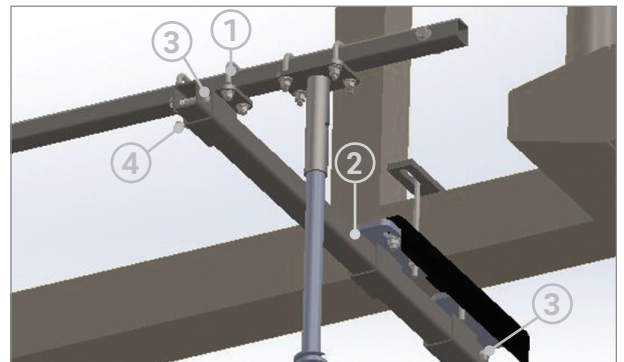

Figure 11

IV. INSTALL RISER TUBE ASSEMBLIES

For each riser tube assembly removed earlier:

Figure 13

Step 1 Reinstall riser tube assembly (1).

Step 2 Install pin (2).

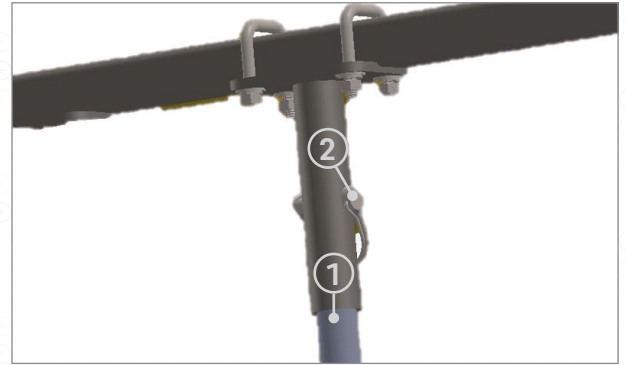

Figure 13

⊕ INSTALLATION COMPLETE.