



INSTRUCTIONS 360 Y-DROP® SQUARE TUBE UPGRADE

MILLER 2008 AND LATER

360YIELDCENTER.COM



INSTRUCTIONS

360 Y-DROP

SQUARE TUBE UPGRADE

MILLER 2008 AND LATER



Figure 1 Before upgrade



Figure 2 Upgrade completed

⊕ RECOMMENDED TOOLS

- + Ratchet wrench with 1/2" and 9/16" deep well sockets
- + 3/8" 12-point socket
- + 1/2" and 9/16" combination wrenches

⊕ TORQUE VALUES

- + Refer to these torque values when tightening all fasteners

+ 5/16" stainless	U-bolt	15 ft/lbs
+ 5/16" stainless	Set screw	15 ft/lbs
+ 3/8" carbon	U-bolt	35 ft/lbs
+ 5/16" carbon	U-bolt	30 ft/lbs
+ 5/16" carbon	Stop bolt	30 ft/lbs

⊕ QUESTIONS

- + Call our Product Support team at 888-512-4890

INSTRUCTIONS 360 Y-DROP SQUARE TUBE UPGRADE MILLER 2008 AND LATER

I. REMOVE RISER TUBE ASSEMBLIES

Follow these steps to remove each riser tube assembly:

Figure 3

Step 1 Remove pin (1).

Step 2 Remove riser tube assembly (2).

Repeat Steps 1-2 for all riser tube assemblies.

Retain riser tube assemblies for later reinstallation.



Figure 3



Figure 4

II. INSTALL MOUNT ASSEMBLIES ON THE OEM PRIMARY BOOM

NOTE: Replace one Z-bar assembly at a time.
The square tube upgrade mount assemblies will be installed in the same location.

Figure 4

Step 1 Remove U-bolt (1).

Figure 5

Step 2 Remove two nuts (1), 14" plate (2), Z-bar (3) and bracket assembly (4).

Step 3 Remove bolt assemblies (5) and the diamond brackets.

Step 4 Repeat Step 2 for the remaining mount assemblies on the OEM primary boom.



Figure 5

INSTRUCTIONS 360 Y-DROP SQUARE TUBE UPGRADE MILLER 2008 AND LATER

II. INSTALL MOUNT ASSEMBLIES ON THE OEM PRIMARY BOOM *(continued)*

Figure 6

Step 5 With the threads pointing down, install diamond U-bolt (1) on the top side of the OEM primary boom.

Step 6 Install diamond boom clamp (2) on the bottom of the OEM primary boom.

Step 7 Install 14" top plate (3).

Step 8 Install bracket assembly (4) and flange lock nuts (5).

Hardware Kit D

Step 9 Install carriage bolts (6) and flange nuts.

Hardware Kit D

Step 10 Install extension tube (7).

Figure 7

Step 11 Install boom bracket (1) onto the extension tube.

Step 12 With the threads pointing down install square U-bolts (2) plus the 5/16" extra thick washers and the 5/16" nuts.

Hardware Kit A

Step 13 Install stop bolts (3) at both the front and the rear of the extension tube.

Hardware Kit B

Figure 8

Step 14 Install stainless steel set screws and jam nut assemblies (1) onto the bracket assemblies.

Hardware Kit D

Repeat Steps 1-14 the remaining mount assemblies on the OEM primary boom.

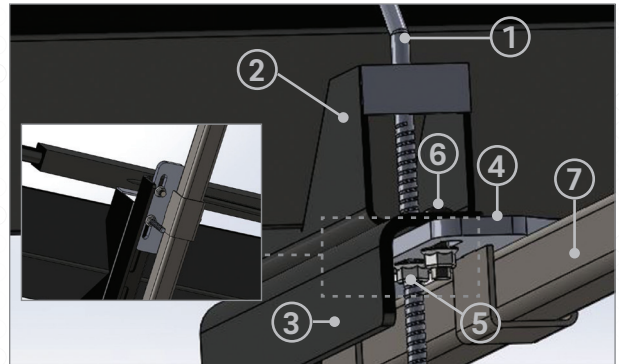

Figure 6

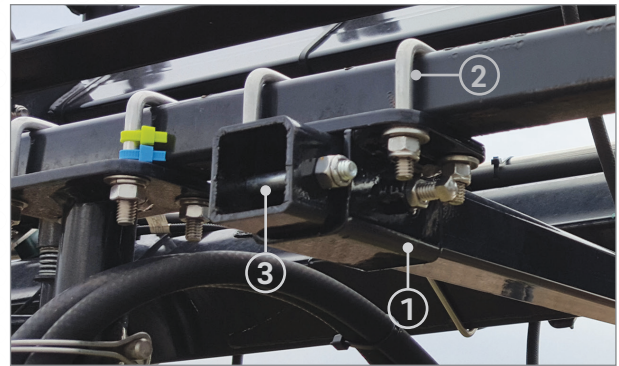

Figure 7

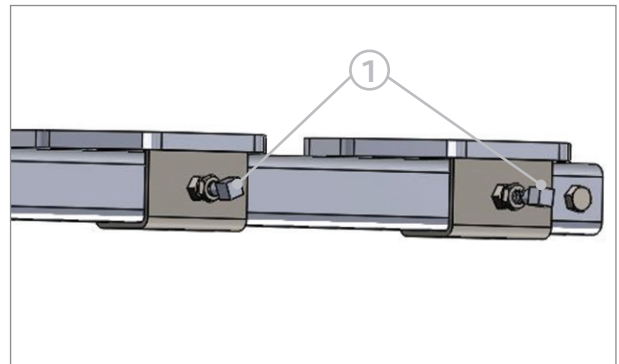

Figure 8

INSTRUCTIONS 360 Y-DROP SQUARE TUBE UPGRADE MILLER 2008 AND LATER

III. INSTALL CENTER SECTION SQUARE TUBE UPGRADE

In preparation for the center section installation:

Figures 9 and 10

Step 1 Remove bolts (1), 13" plate (2), 5" top plate (3), Z-bar (4) and bracket assembly (5). Repeat for the remaining mount assemblies on the OEM center section.

Figure 11

Step 2 Install bolts (1) over the OEM center section boom.

Step 3 Place 14" top plates (2), spacer plate (3) and bracket assembly (4) into position and install 3/8" flange nuts (5).

Step 4 Install extension tube (6) onto bracket assembly (4).

Step 5 Install carriage bolts (7) and the flange nuts.

Step 6 Install boom bracket (8).

Step 7 Install stop bolt assemblies (9) at the front and rear of the extension tube.

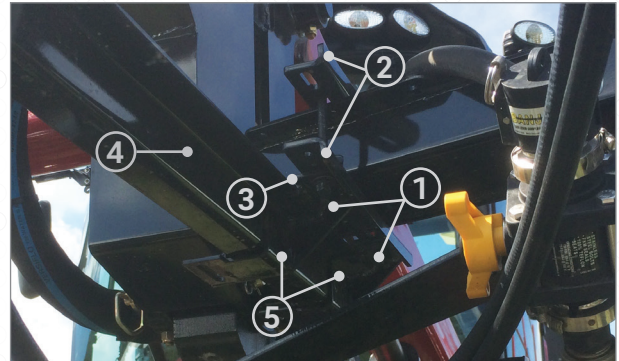

Figure 9

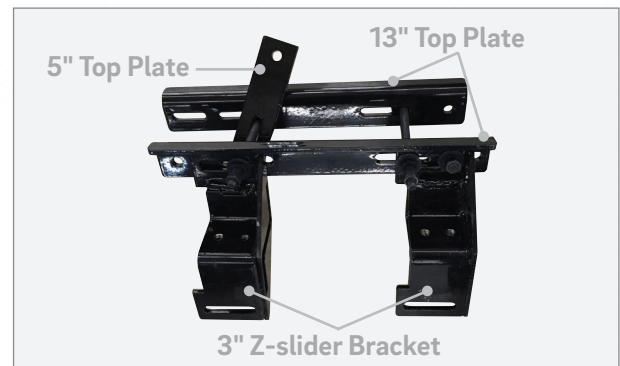

Figure 10

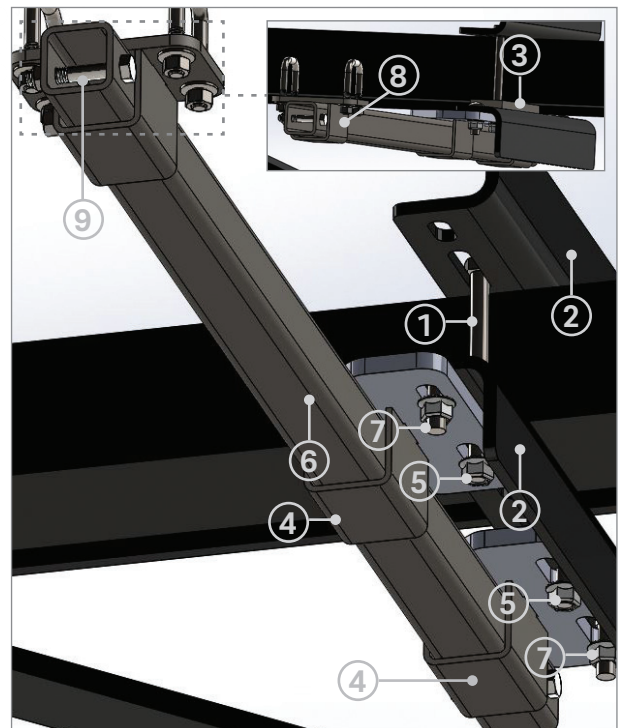

Figure 11

INSTRUCTIONS 360 Y-DROP SQUARE TUBE UPGRADE

MILLER 2008 AND LATER

III. INSTALL CENTER SECTION SQUARE TUBE UPGRADE *(continued)*

Figure 12

Step 9 Install stainless steel set screws and jam nut assemblies (1).

Figure 13

Step 10 Reinstall riser tube assembly (1) and secure with pin (2) from those removed earlier. Repeat for remaining riser tube assemblies.



Figure 12



Figure 13

⊕ INSTALLATION COMPLETE.



360YIELDCENTER.COM

All other trademarks are the property of 360 Yield Center, its affiliates and/or its licensors.
©2016 360 Yield Center. All rights reserved. YCG16010-2