

INSTALLATION INSTRUCTIONS

JOHN DEERE 7000 & KINZE 2000



HELPFUL TOOLS

- Hammer/Mallet
- Wrench Sizes: 3/4", 9/16" and 15/16"
- Socket Sizes: 3/4", 9/16" and 15/16"
- Impact

NEED HELP?

Call our Product Support Team at 888-512-4890.

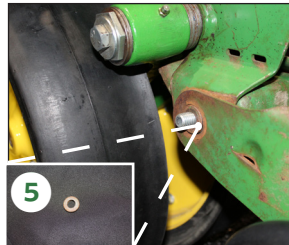
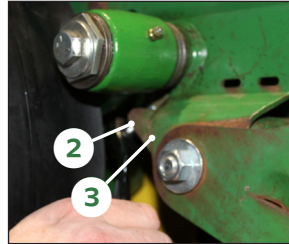
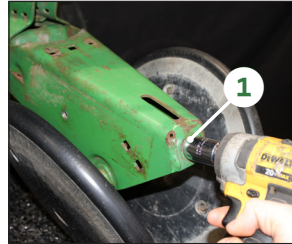

STEP 1 | REMOVE CLOSING SYSTEM

Using a 3/4" socket, withdrawal the tensioning bolt **1** from the spring.

Using a 9/16" socket remove the bolt **2** that holds the top of the closing wheel arm stop **3** to the row unit.

NOTE: Gauge wheels may need to be held up while removing the bolt.

Using a 3/4" socket and wrench remove bolts **4** holding closing system on. Keep the bushing **5** and discard the bolts, washers, and nuts.

Remove spring from closing wheel arm stop and if not already, disengage from the closing system.

NOTE: Retain closing wheel arm stop and hardware in a safe location for installing closing wheels without 360 BANDIT.

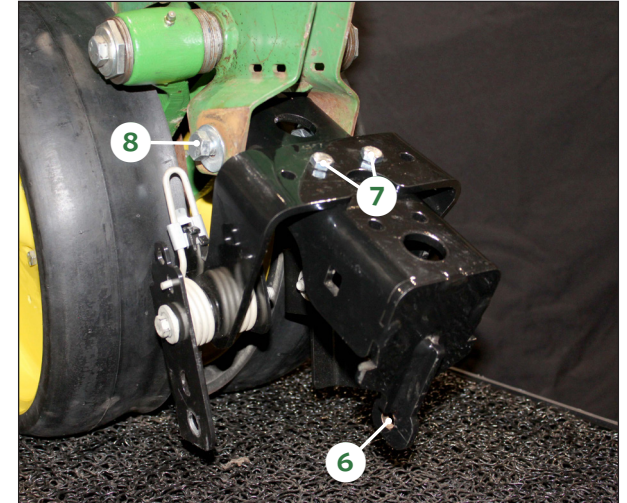

STEP 2 | ASSEMBLE BANDIT ARM ASSEMBLY (KIT #540560) & EXTENSION BRACKET

Slide the BANDIT arm assembly over the extension bracket. Ensure BANDIT arms are facing in the rearward direction towards the spring hook **6**.

Secure arm assembly to the front holes **7** on the extension bracket with (2) 3/8" x 1-1/2" bolts and 3/8" flange nuts.

Tighten with 9/16" socket and wrench.

STEP 3 | INSTALL BANDIT EXTENSION BRACKET

NOTE: Leave nyloc nuts loose on both sides until after the support strap is installed in STEP 5.

Align holes in extension bracket with the holes on the row unit. Install flat washer on 1/2" x 1-1/2" bolt from hardware kit #540615. Slide bolt through extension bracket and row unit hole (bolt head on the outside) **8**. Install another washer and hand tighten with nyloc nut from hardware kit #540615. Do not tighten.

Repeat on other side.

INSTALLATION INSTRUCTIONS

JOHN DEERE 7000 & KINZE 2000

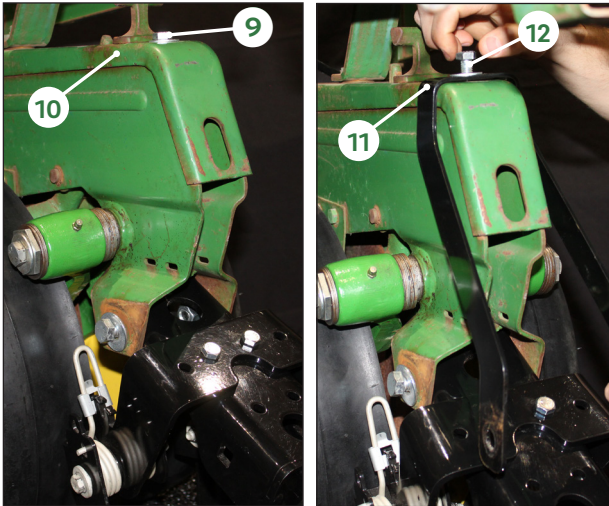

STEP 4 | INSTALL SUPPORT STRAP

Using a 9/16" socket, remove the bolt 9 from the top of the depth adjustment assembly 10 and discard.

Secure the top of the support strap 11 to the depth adjustment assembly using the supplied 3/8" x 1-1/4" bolt 12 and washer from hardware kit #540615. Ensure all bracketry is flush when bolt is installed.

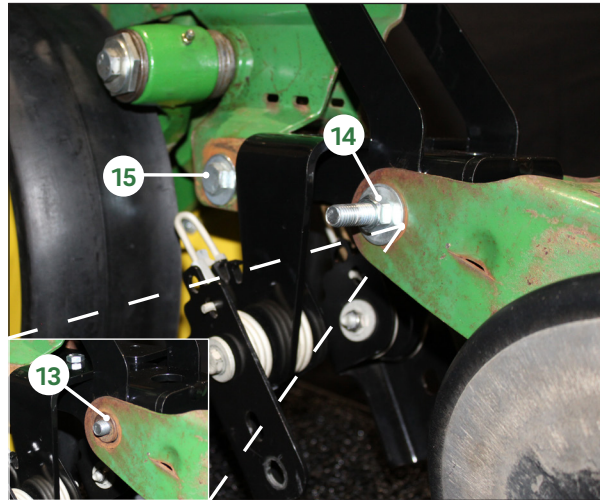

STEP 5 | INSTALL CLOSING SYSTEM

Attach the spring to the spring hook on the extension bracket.

NOTE: The amount of spacer washers required will differ between planters/row units. Spacer washers are provided to fill the gap between the closing wheel arms and the BANDIT extension bracket. Use the quantity of spacer washers required for your system.

Insert the 2-1/4" carriage bolt, with flat head on the inside, through the square carriage bolt hole on the extension bracket and through the support strap arms. Install any needed washers and then slide bolt through closing system arms. Install previously set aside bushing 13 and secure with large flat washer and 1/2" nyloc nut 14 from hardware kit #540620 using 3/4" socket.

Repeat on other side.

Tighten the nyloc nuts 15 that were left loose in STEP 3 with a 3/4" socket and wrench, securing the BANDIT extension bracket to the row unit.



STEP 5 | INSTALL CLOSING SYSTEM (continued)

Install tensioning bolt onto spring and apply applicable tension.

INSTALLATION INSTRUCTIONS

JOHN DEERE 7000 & KINZE 2000

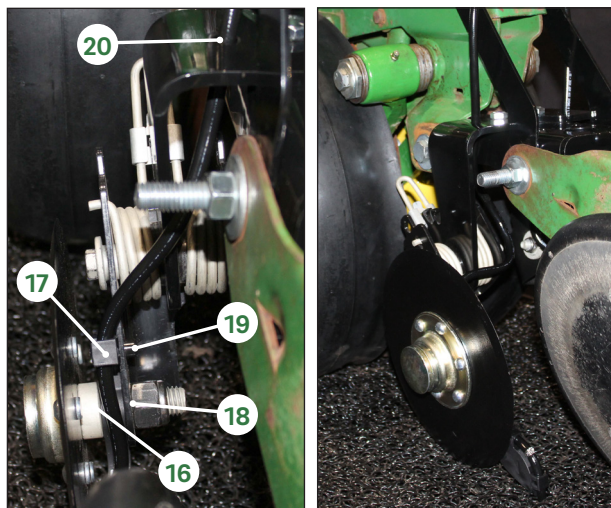

STEP 6 | INSTALL CLOSING SYSTEM

NOTE: Hose guides are labeled "L" left and "R" right. When holding them in your hands with the ear tabs facing each other, your left hand will be holding the left side hose guide and your right hand will be holding the right side.

NOTE: The supplied 3/8" x 1" bolt installed in the BANDIT pin up hole is to be used as a "zero" setting and as a stop in case of spring disengagement.

Insert 5/8"x 3" bolt through the disk. Insert bushing **16** (large side first) and hose guide assembly **17** (ear tab facing out).

Slide assembly into the lower hole **18** on the BANDIT, aligning the ear tab with corresponding upper hole **19** and secure with lock nut.

Tighten with 15/16" socket and wrench.

Using a mallet, install provided dust caps over bolt heads.

Route application hose through hole in top of 360 BANDIT frame **20**.

Repeat for other side.

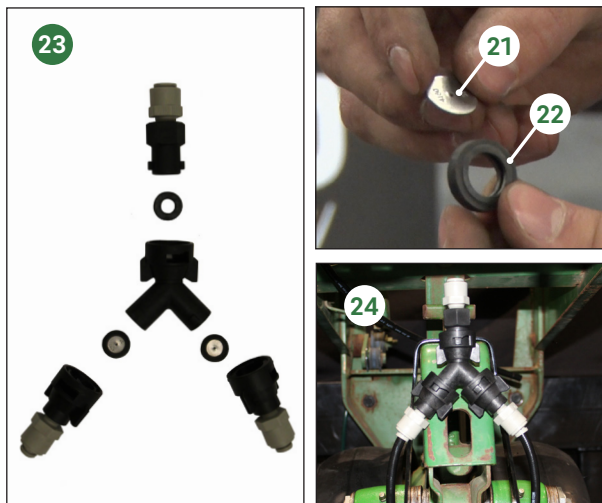

STEP 7 | ASSEMBLE PLUMBING

NOTE: If hoses are not fully seated in the push to connect, they will leak. Hoses seat 7/8" of an inch deep or until you hear a snap.

Install orifice plates **21** in the rubber grommets **22**.

Assemble plumbing components in the arrangement shown above **23**. The supplied push to connect adapter in the 360 BANDIT kit connects to 3/8" push to connect compatible hose.

Secure hoses to row unit with provided zip ties **24**.

PLUMBING RECOMMENDATIONS:

To prevent excess fertilizer from dribbling out of the hoses when product application is shut off, install one push to connect polypropylene (Inlet x Outlet) 3/8" O.D. check valve (not included) in the plumbing to each row prior to the 360 BANDIT orifices. Check valve is available at Dultmeier Sales (Item #BUCV1103-P38).

A 50 mesh strainer (not included) can be used in the complete plumbing system between tanks and 360 BANDIT to help prevent debris from blocking orifices.



INSTALLATION COMPLETE