



# 360 BANDIT™

## ROCK GUARD INSTALLATION INSTRUCTIONS KINZE 3000 MODELS



[360YIELDCENTER.COM](http://360YIELDCENTER.COM)

FOR QUESTIONS PLEASE CONTACT OUR  
PRODUCT SUPPORT TEAM AT 309-300-3120

5.14.19 • V1



# ROCK GUARD KIT INSTALLATION

KINZE 3000



## STEP 1 REMOVE BOLTS

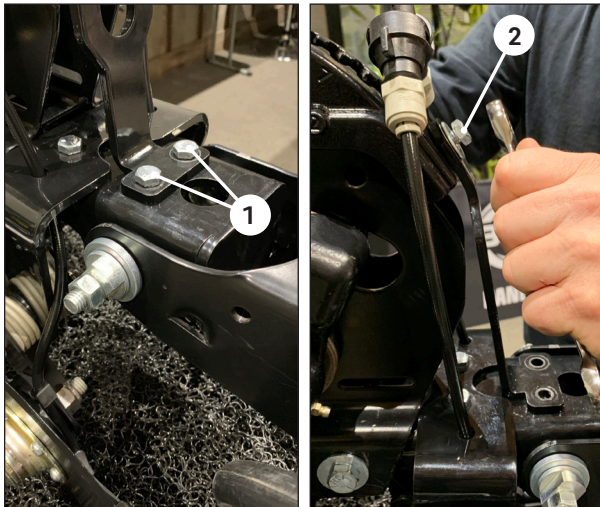

Using a 9/16" wrench and socket remove the (2) 3/8" bolts **1** that secures the support strap to the 360 BANDIT extension bracket. The bolt and nut can be discarded.

Loosen, but do not completely remove, the top bolt **2** that secures the support strap to the depth adjustment assembly.

## STEP 2 PLACE ROCK GUARD

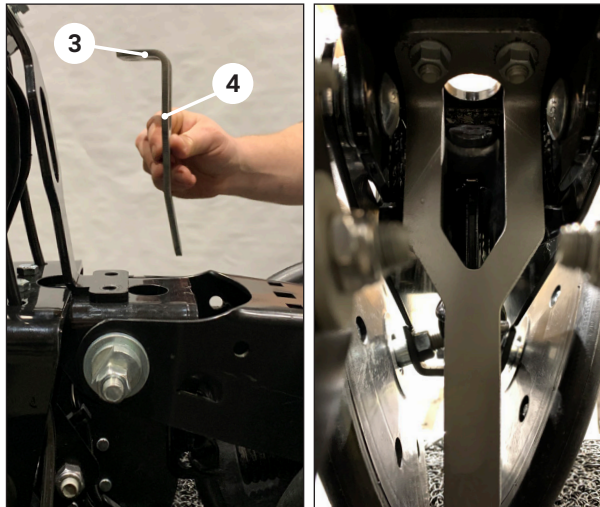

Orient the rock guard **3** so that the guard extension **4** is to the rear.

From the underside, maneuver the rock guard around the two side closing system bolts and align the rock guard bracket with the holes in the 360 BANDIT extension bracket.

## STEP 3 SECURE ROCK GUARD AND SUPPORT STRAP

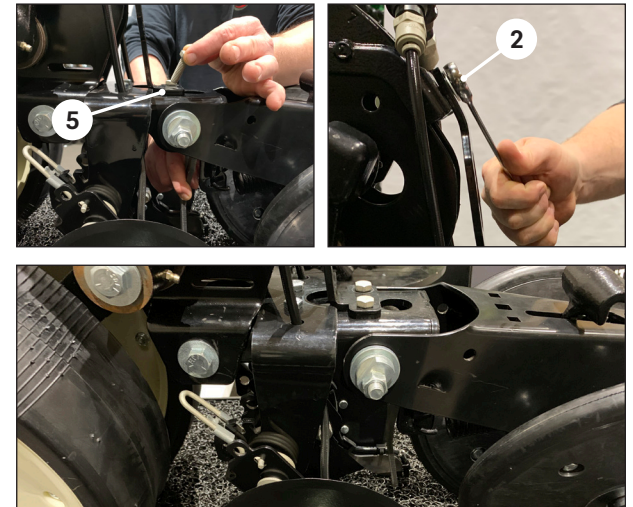

From the top, install the (2) provided 3/8" bolts **5** through the support strap, 360 BANDIT extension bracket and rock guard.

Secure with provided nut. Tighten with a 9/16" socket and wrench.

Tighten the top bolt **2** that secures the support strap to the depth adjustment assembly.

**INSTALLATION COMPLETE**