



360 WAVE™

INSTALLATION INSTRUCTIONS
KINZE MODELS
WITHOUT 360 BANDIT



360YIELDCENTER.COM

FOR QUESTIONS PLEASE CONTACT OUR
PRODUCT SUPPORT TEAM AT 309-300-3120

3.26.20 • V1

INSTALLATION INSTRUCTIONS

KINZE MODELS WITHOUT BANDIT



STEP 1

PREPARE THE ROW UNIT

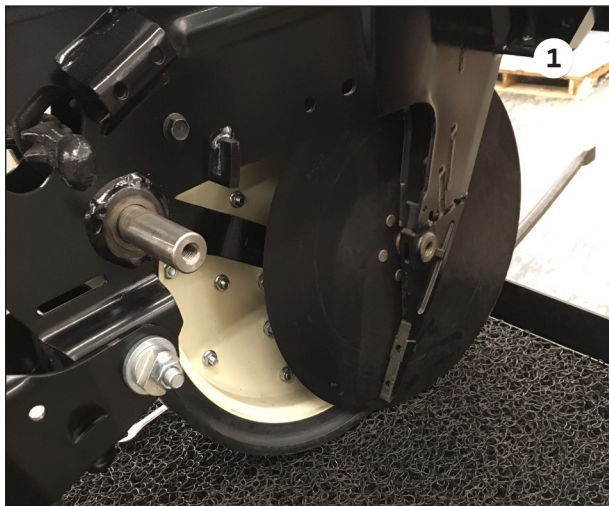

Remove both gauge wheels and the right-side opening disk ①.

STEP 2

REMOVE CLOSING ASSEMBLY

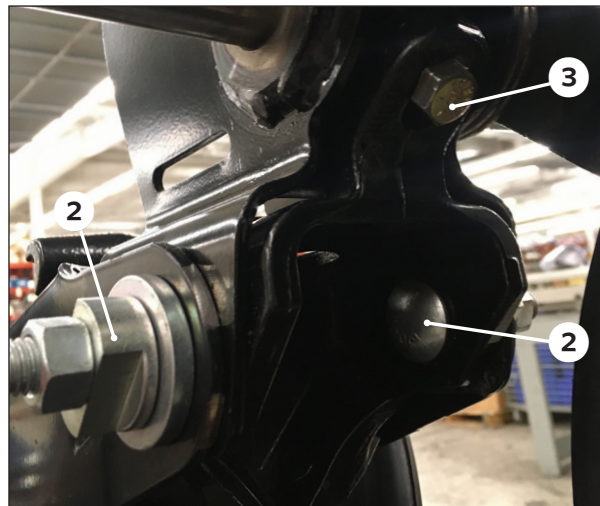

Remove the (2) carriage bolts ② and one regular bolt ③ that secure the closing casting to the row unit.

Save the two carriage bolts and nuts as they will be reused.

Remove the closing casting.

Unhook the closing spring and remove the closing assembly.

STEP 3

INSTALL NEW CLOSING CASTING

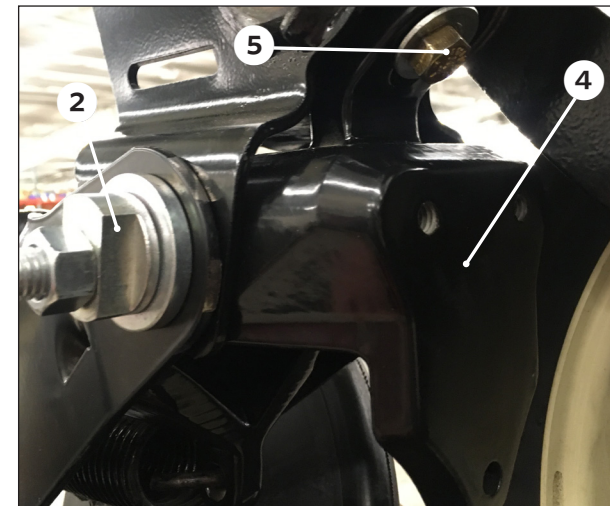

Install the provided closing casting ④ using the previously removed carriage bolts ② and the provided 3/8" bolt ⑤.

NOTE: Ensure the front face of the new closing casting is vertical prior to tightening.

Reinstall the closing system and secure with the previously removed nuts. Be sure to re-hook the closing spring.

INSTALLATION INSTRUCTIONS

KINZE MODELS WITHOUT BANDIT



STEP 4

INSTALL WAVE ASSEMBLY

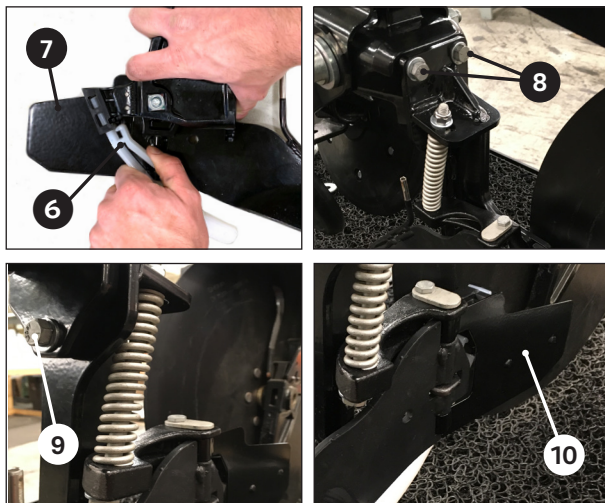

Install firm **6** on the wave assembly **7** by pinching the top of the firm together and slide it into place.

Install the WAVE assembly on the WAVE mounting bracket using the provided hardware. Two bolts will be inserted on the front **8** and one on the back **9** of the assembly.

NOTE: When installing the WAVE assembly ensure the blade trash guard is flush against the seed tube protector **10**.

STEP 5

INSTALL PLUMBING

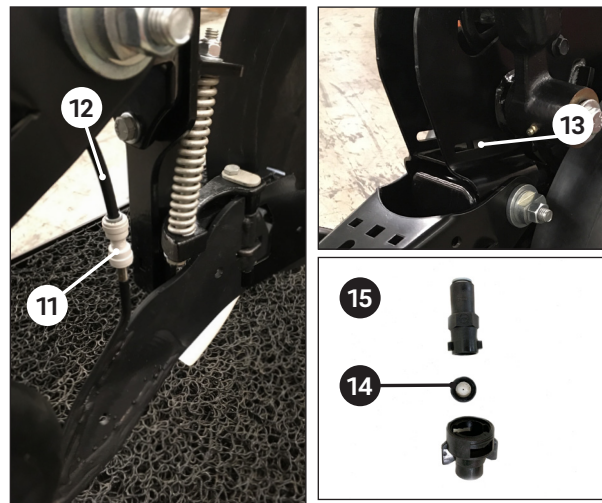

Install the push-to-connect fitting **11** on the liquid tube on WAVE assembly.

Route the 1/4" push-to-connect line **12** through the hole **13** on the row unit and connect it to the push-to-connect fitting just installed.

Assemble the orifice into the rubber grommet **14**.

Assemble the three plumbing components in the arrangement shown above **15**.

Attach the plumbing assembly to the other end of the 1/4" line. Secure the line to the row unit using zip ties as you see fit.

STEP 6

REINSTALL GAUGE WHEELS AND DISK



Reinstall right side disk and both gauge wheels using original hardware.

INSTALLATION COMPLETE

NOTE: Backing up when planter is not raised can cause wave blade to catch in the ground and bend or break. Use care to only back up after planter row unit is disengaged from the ground.