



360 BANDIT



360 BANDIT™

INSTALLATION INSTRUCTIONS GREAT PLAINS MODELS



360YIELDCENTER.COM

**FOR QUESTIONS PLEASE CONTACT OUR
PRODUCT SUPPORT TEAM AT 309-300-3120**

5.26.20 • V4

All trademarks are the property of 360 Yield Center, its affiliates and/or its licensors. ©2019 360 Yield Center. All rights reserved.

INSTALLATION INSTRUCTIONS

GREAT PLAINS



BEFORE YOU BEGIN...

HELPFUL TOOLS



Hammer/Mallet

Wrench Sizes: 15/16" and 7/16"

Socket Sizes: 16mm, 15/16", 18mm and 7/16"

Impact

Torque Wrench

STEP 1

REMOVE CLOSING SYSTEM

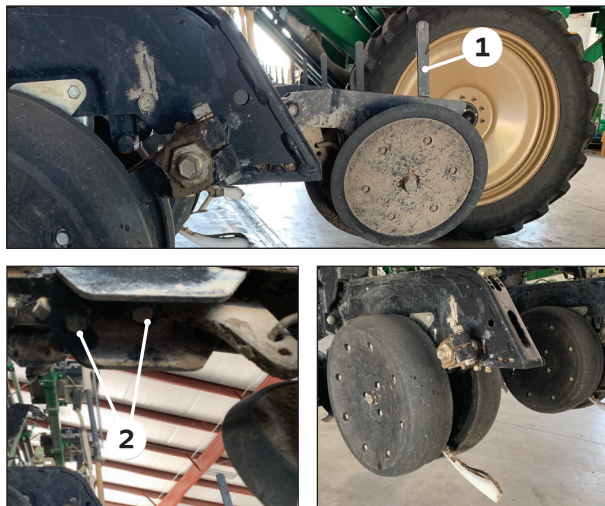

Release spring ① to remove tension from closing system.

NOTE: If the optional chains kit is not being installed do not remove the closing wheels.

If present, remove insecticide attachment.

Using an 3/4" socket remove the two bolts that attach the closing system casting ② to the row unit and set the closing system casting aside. Bolts can be discarded.

STEP 2

INSTALL BANDIT UNIT

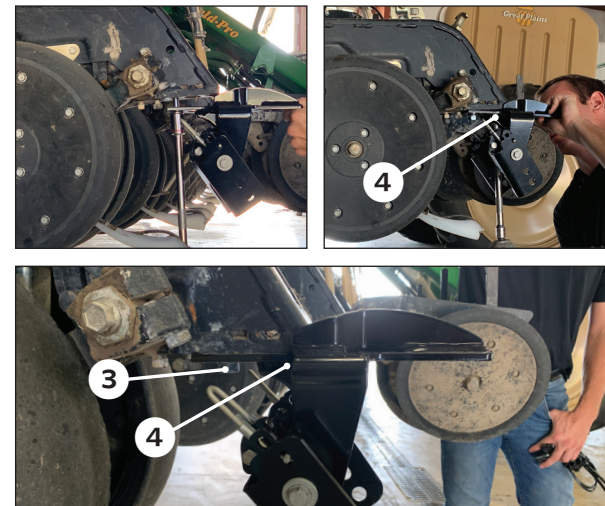

Using one of the long bolts ③ and one of the short bolts ④ from the provided hardware kit, attach the 360 BANDIT unit (long leg to the rear) to the row unit where the closing system casting was just removed. The longer bolt will be used in the front hole and the shorter bolt will be used in the rear hold.

Tighten with 16 mm socket. Torque bolts to 42.2 ft lbs.
Ensure not to over tighten bolts.

INSTALLATION INSTRUCTIONS

GREAT PLAINS



STEP 3

PREPARE HOSE GUIDES

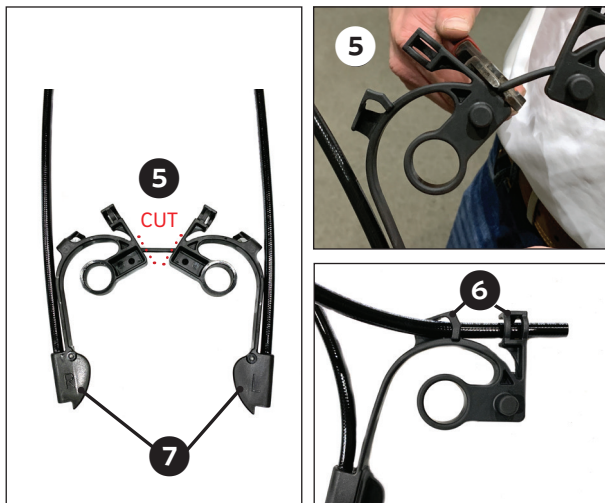

Using side-cutters, cut the two hose guides apart ⑤.
Route the hose through the top two holes in the hose guide ⑥.
Hose guides are labeled “L” left and “R” right ⑦.

NOTE: When installing hoseguides on the row unit, left and right are determined from the operators seat.

STEP 4

INSTALL DISK ASSEMBLY

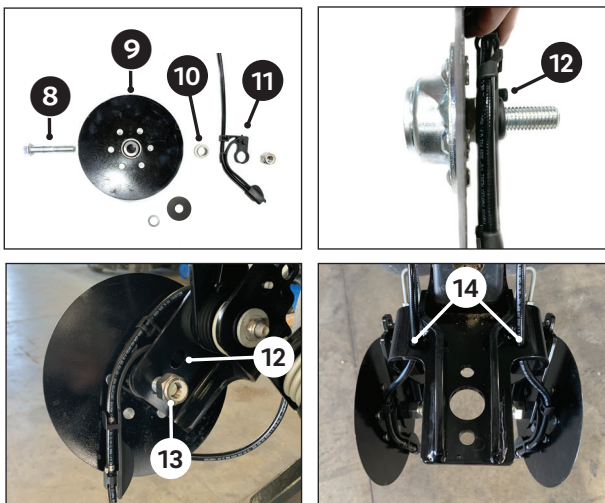

Insert 5/8" X 3" bolt ⑧ through the disk ⑨. Place small shim washer then fender washer over the bolt. Insert bushing ⑩ (large side first) and hose guide assembly ⑪ (ear tab ⑫ facing in).

Slide bolt of the disk assembly into the lower hole on the bandit ⑬, aligning the ear tab ⑫ with corresponding upper hole and secure with lock nut.

Tighten with 15/16" socket and wrench. Check to ensure that the disk freely turns. If the disk does not freely turn, back off the lock nut slightly until the disk freely turns.

Repeat for other side.

Route application hoses through hole in top of 360 BANDIT frame ⑭.

Using a mallet, install provided dust caps over disk bolt heads.

STEP 5

REINSTALL CLOSING SYSTEM

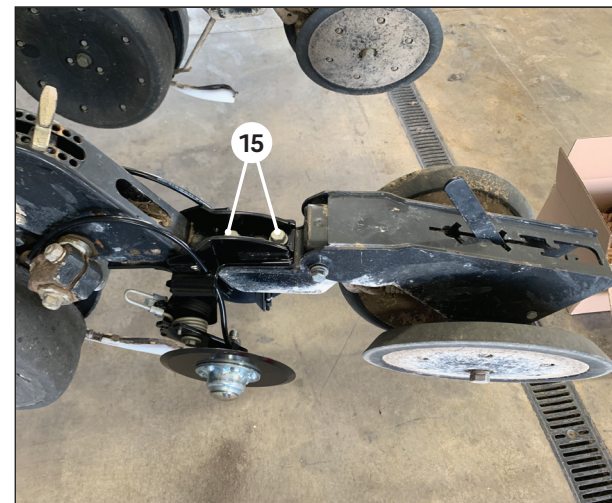

Using two remaining bolts and washers reinstall the closing system to the BANDIT unit ⑮. Secure with nut.

Torque bolts to 42.2 ft lbs. **Ensure not to over tighten bolts.**

Reinstall insecticide attachment, if present.

INSTALLATION INSTRUCTIONS

GREAT PLAINS



STEP 6

ASSEMBLE PLUMBING

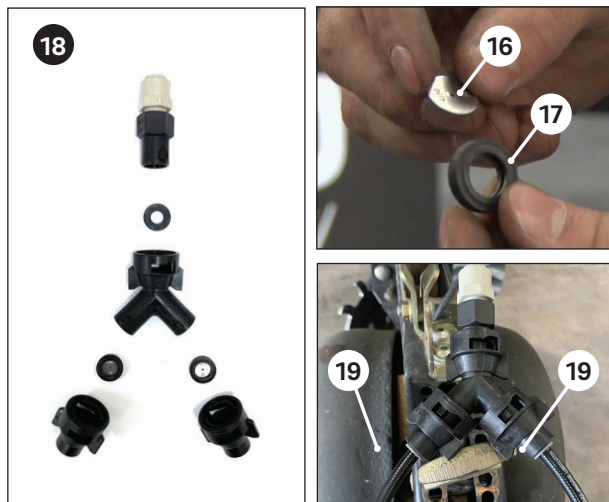

Install orifice plates **16** in the rubber grommets **17**.

Assemble plumbing components in the arrangement shown above **18**.

Attach the plumbing assembly to each of the hoses coming from the house guides **19**.

NOTE: If hoses are not fully seated in the push to connect, they will leak. Hoses seat 7/8" of an inch deep or until you hear a snap.

The supplied push to connect adapter in the 360 BANDIT kit connects to 3/8" push to connect compatible hose.

Secure hoses to row unit with provided zip ties.

INSTALLATION COMPLETE



PLUMBING RECOMMENDATIONS:

To prevent excess fertilizer from dribbling out of the hoses when product application is shut off, install one push to connect polypropylene (Inlet x Outlet) 3/8" O.D. check valve (not included) in the plumbing to each row prior to the 360 BANDIT orifices. Check valve is available at Dultmeier Sales (Item #BUCV1103-P38).

A 50 mesh strainer (not included) can be used in the complete plumbing system between tanks and 360 BANDIT to help prevent debris from blocking orifices.