



360 BANDIT™

INSTALLATION INSTRUCTIONS
HARVEST INTERNATIONAL MODELS



360YIELDCENTER.COM

FOR QUESTIONS PLEASE CONTACT OUR
PRODUCT SUPPORT TEAM AT 309-300-3120

3.10.21 • V6

All trademarks are the property of 360 Yield Center, its affiliates and/or its licensors. ©2019 360 Yield Center. All rights reserved.

INSTALLATION INSTRUCTIONS

HARVEST INTERNATIONAL



BEFORE YOU BEGIN...

HELPFUL TOOLS

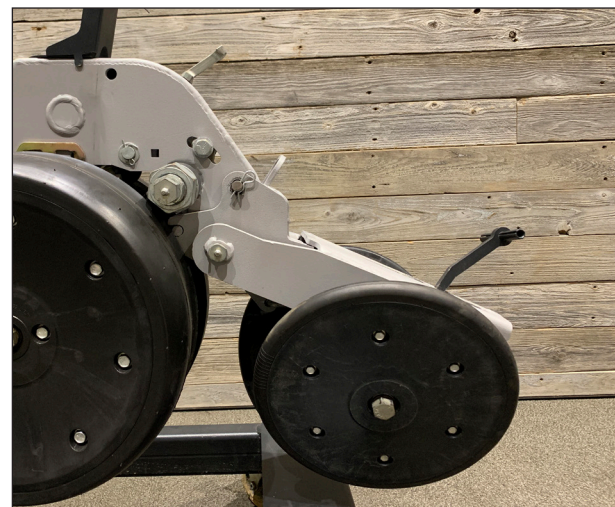

Hammer/Mallet

Wrench Sizes: 15/16" and 3/4"

Socket Sizes: 15/16" and 3/4"

Impact Driver/ Socket Wrench

Torque Wrench

Side Cutters

STEP 1

REMOVE CLOSING SYSTEM

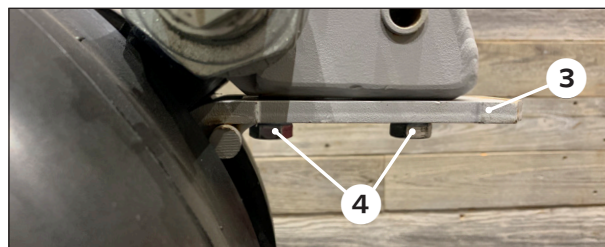
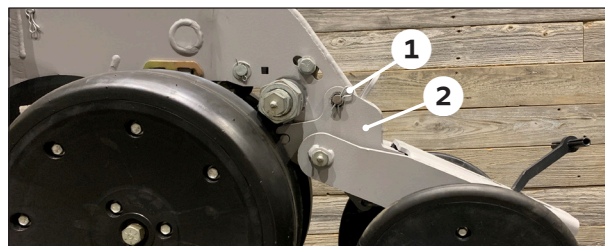

Remove the hair clip and pin from row unit **1** and slide the closing system **2** off.

If present, remove insecticide attachment.

Using an 3/4" socket remove the two bolts **3** that attach the closing system plate **4** to the row unit. Bolts can be discarded but the plate should be retained.

STEP 2

INSTALL BANDIT UNIT

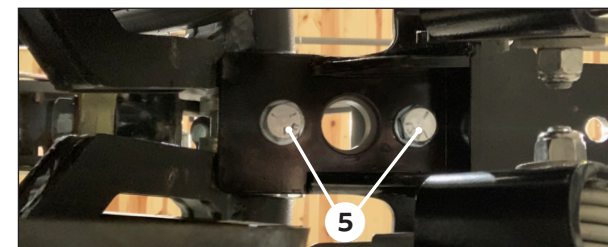
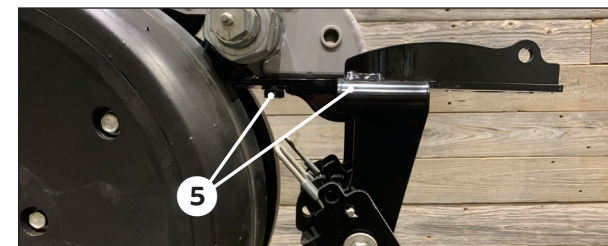

Using the two short 1/2" bolts **5** attach the 360 BANDIT unit (long leg to the rear) to the row unit where the closing system plate was just removed.

Tighten with 3/4" socket. Torque bolts to 57 ft lbs. **Ensure not to over tighten bolts.**

NOTE: The supplied 3/8" x 1" bolt installed in the BANDIT pin up hole is to be used as a "zero" setting and as a stop in case of spring disengagement.

INSTALLATION INSTRUCTIONS

HARVEST INTERNATIONAL



STEP 3

INSTALL ROCK GUARD

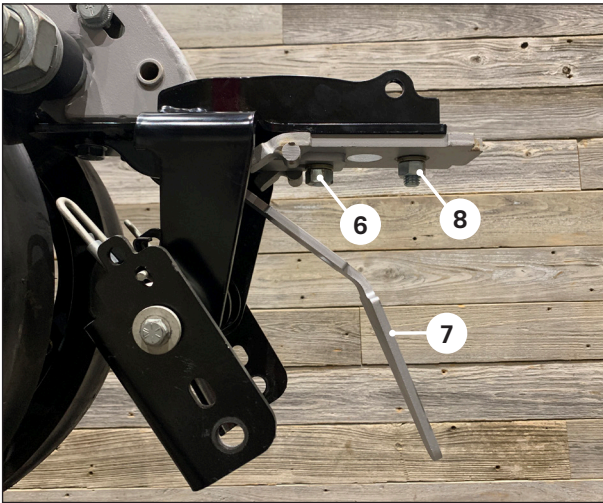

Insert one of the longer 1/2" bolts **6** through the rock guard **7** and then through the front hole on the closing system plate. Secure to the BANDIT unit.

Insert the second 1/2" bolt through the rear hole of the closing system plate **8** and secure to the BANDIT unit.

Tighten both using 3/4" wrench and socket.

STEP 4

PREPARE HOSE GUIDES

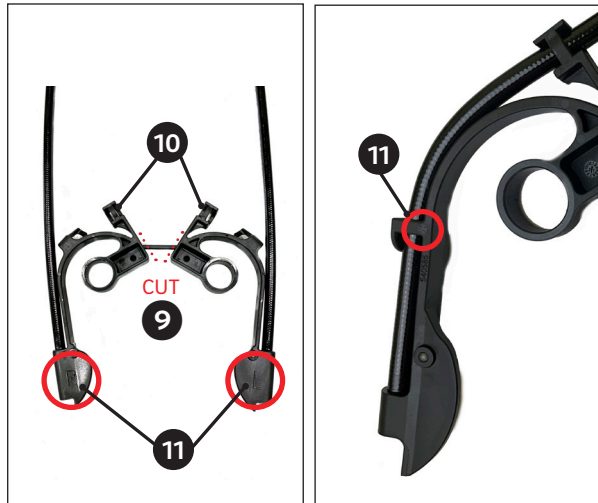

Using side-cutters, cut the two hose guides apart **9**.

Ensure the hose is routed through the top two holes in the hose guide **10**.

Hose guides are labeled "L" left and "R" right. Location of the "L" and "R" marking may vary - see pictures above for an example of each possible marking location **11**.

NOTE: When installing hoseguides on the row unit, left and right are determined from the operators seat.

STEP 5

INSTALL DISK ASSEMBLY

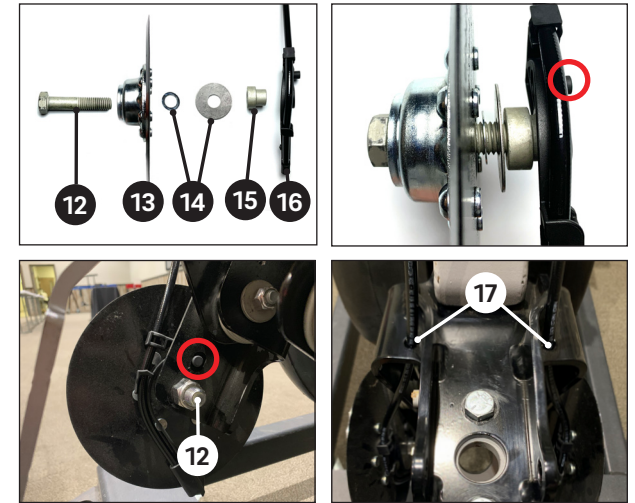

Insert 5/8" X 3" bolt **12** through the disk **13**. Place small shim washer then fender washer **14** over the bolt. Insert bushing **15** (large side first) and hose guide assembly **16** (ear tab facing in).

Slide bolt of the disk assembly into the lower hole on the bandit **12**, aligning the ear tab with corresponding upper hole and secure with lock nut.

Tighten with 15/16" socket and wrench. Check to ensure that the disk freely turns. If the disk does not freely turn, back off the lock nut slightly until the disk freely turns.

Using a mallet, install provided dust caps over disk bolt heads.

Route application hose through hole in top of 360 BANDIT frame **17**.

Repeat for other side.

INSTALLATION INSTRUCTIONS

HARVEST INTERNATIONAL



STEP 6

REINSTALL CLOSING SYSTEM

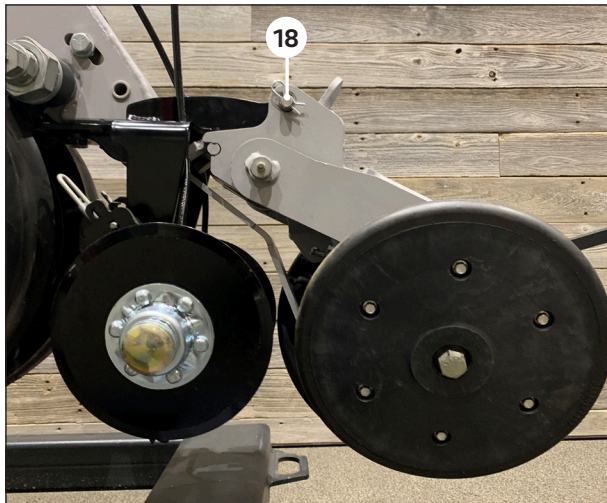

Slide the closing system into place, ensuring the pin hole lines up with the hole on the BANDIT unit.

Using the previously removed pin and hair clip **18** or the provided pair of 1/2" bolts and nuts, secure the closing system to the BANDIT unit.

Reinstall insecticide attachment, if present.

STEP 7

ASSEMBLE PLUMBING

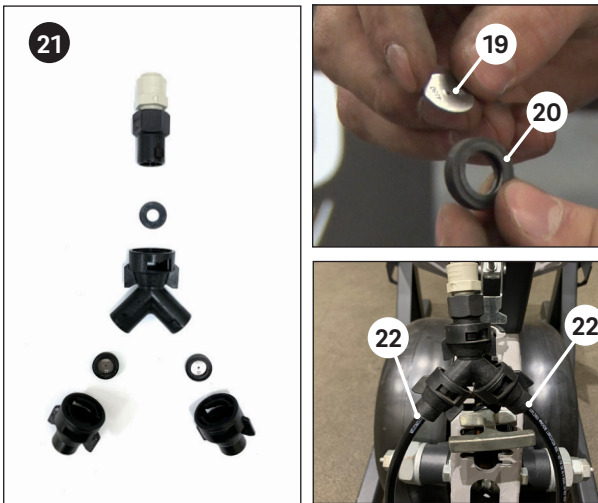

Install orifice plates **19** in the rubber grommets **20**.

Assemble plumbing components in the arrangement shown above **21**.

Attach the plumbing assembly to each of the hoses coming from the house guides **22**.

NOTE: If hoses are not fully seated in the push to connect, they will leak. Hoses seat 7/8" of an inch deep or until you hear a snap.

The supplied push to connect adapter in the 360 BANDIT kit connects to 3/8" push to connect compatible hose.

Secure hoses to row unit with provided zip ties.

INSTALLATION COMPLETE



PLUMBING RECOMMENDATIONS:

To prevent excess fertilizer from dribbling out of the hoses when product application is shut off, install one push to connect polypropylene (Inlet x Outlet) 3/8" O.D. check valve (not included) in the plumbing to each row prior to the 360 BANDIT orifices. Check valve is available at Dultmeier Sales (Item #BUCV1103-P38).

A 50 mesh strainer (not included) can be used in the complete plumbing system between tanks and 360 BANDIT to help prevent debris from blocking orifices.