



360 TANKS™

INSTALLATION INSTRUCTIONS
JOHN DEERE 8RT MODELS



360YIELDCENTER.COM

FOR QUESTIONS PLEASE CONTACT OUR
PRODUCT SUPPORT TEAM AT 309-300-3120

11.21.22 • V2

INSTALLATION INSTRUCTIONS

JOHN DEERE 8RT



HELPFUL TOOLS



Impact

Socket Sizes: 30mm, 5/16", 7/16", 9/16" and 1-1/8"

15/16" Deep Well Socket

Wrench Sizes: 1-1/8", 15,16", and 9/16"

5/16" Nut Driver

Phillips Screw Driver

Anti-seize

WD-40

Pipe Thread Sealant

White Thread Sealing Tape

Remember right and left sides of the tractor are determined from the operator's seat. Left side is the ladder side.

STEP 1 TRACTOR PREP



Remove weights and OEM weight bracket **1**.

NOTE: Set OEM weight bracket aside as it will be reinstalled at a later step.

Remove fenders, toolboxes, and brackets attached to mounting location on tractor frame that would cause interference of the tank mounting structure.

Remove both taillights and flood lights on the rear of the tractor.

STEP 2 FRONT MOUNT BRACKET

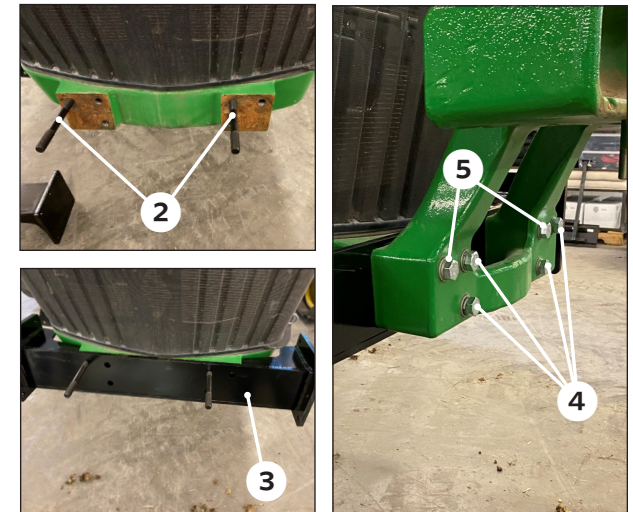

Install the provided 20mm studs **2** into any hole on each side of the weight bracket mounting location.

Slide the front weight mount bracket **3** on to studs.

Secure the OEM weight bracket to the front mount bracket by installing four of the long 20 mm bolts **4** in the remaining empty holes on the bracket.

Then remove the 20 mm studs and replace with the two remaining 20 mm bolts **5**.

Tighten all six bolts completely.

INSTALLATION INSTRUCTIONS

JOHN DEERE 8RT



STEP 3

LEFT SIDE TRANSMISSION MOUNT BRACKET

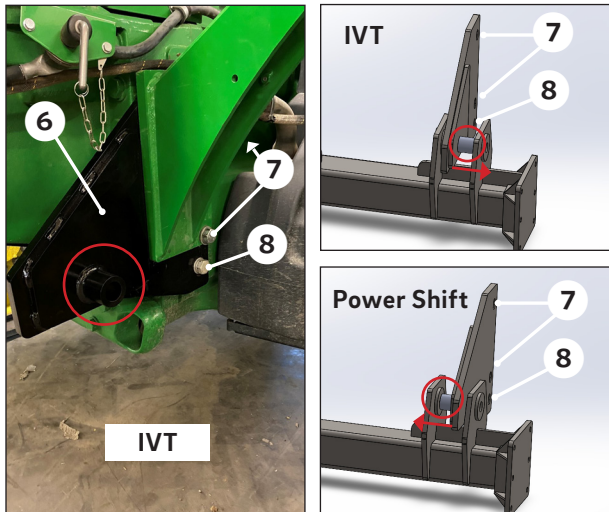

Support the bottom of the ladder and slide it to farthest point out from the tractor.

Remove the two 20 mm bolts that secure the ladder to the tractor frame.

IVT transmission: Slide the transmission mount bracket **6** in behind the ladder with the bushing protruding out (pictured above).

Powershift transmission: Slide the transmission mount bracket in behind the ladder with the bushing recessed in towards the tractor.

Secure by sliding the two 70mm x 20 mm bolts **7** through the ladder, transmission mount bracket and tractor frame and tighten. Insert the 50mm x 20mm bolt **8** through the transmission mount bracket and tractor frame and tighten.

NOTE: Leave the ladder slid out at the farthest point from the tractor.

STEP 4

RIGHT SIDE TRANSMISSION MOUNT BRACKET

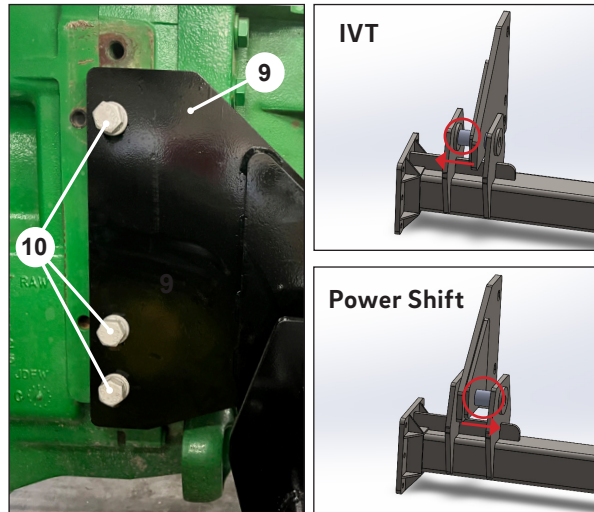

On the right side of the tractor, remove the OEM casting.

IVT transmission: Install the transmission mount bracket **9** with the bushing protruding out. (pictured above).

Powershift transmission: Install the transmission mount bracket with the bushing recessed in towards the tractor.

Secure with the three 50mm x 20 mm bolts **10**.

STEP 5

UNDER TRACTOR SUPPORT

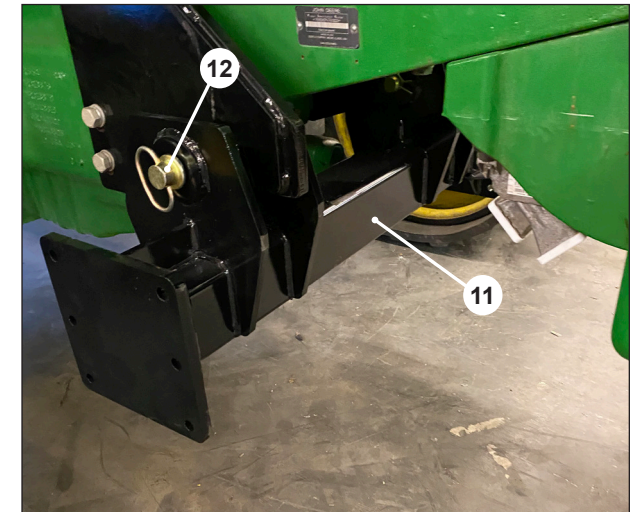

Using a floor jack, lift the under tractor support **11** into place and secure to the transmission mount brackets using the two 1-1/4" pins **12** (one pin on the left and one on the right).

INSTALLATION INSTRUCTIONS

JOHN DEERE 8RT



STEP 6

UNDER TANK SUPPORT

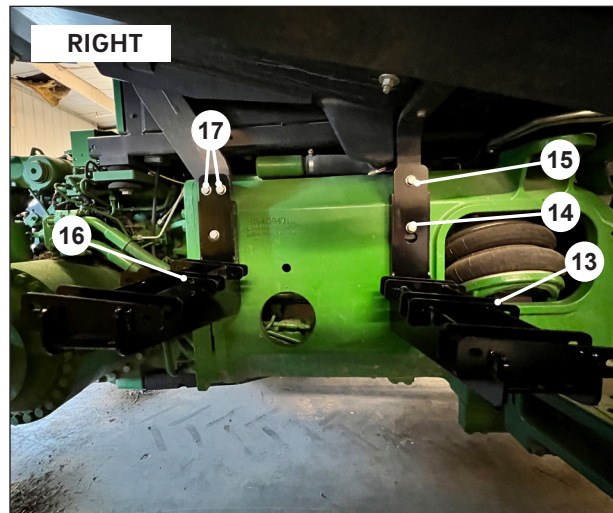

NOTE: The under tank supports are right/left specific. When completely installed all under tank supports should be angled towards the front.

On the back fuel tank holding casting remove the top bolt completely and loosen the bottom bolt. Slide the first of three under tank support brackets **13** onto the loosened bolt **14**. Insert the provided 80mm M16 bolt **15** into the top hole. Tighten both bolts.

On the front fuel tank holding casting remove only the top two bolts. **NOTE: The bottom bolt should remain in place and tightened.** Install the second of three under tank support brackets **16** using the two 80mm M16 bolts **17**. Tighten.

STEP 6 CONTINUED

UNDER TANK SUPPORT

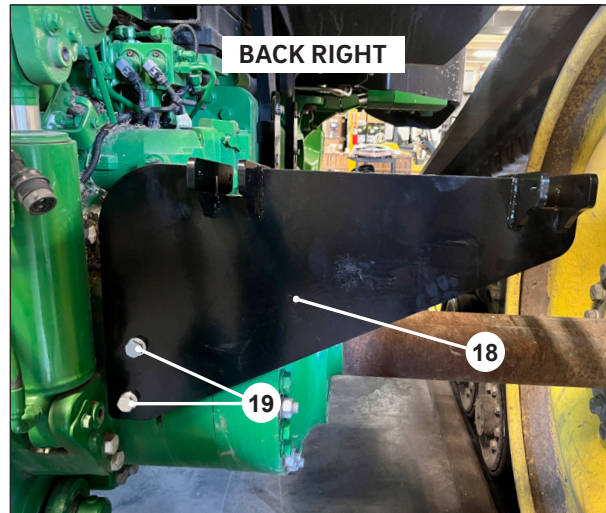

Secure the rear-most under tank support bracket **18** to the differential casting using two 80mm M16 bolts **19** provided.

Repeat for left under tank support brackets.

STEP 7

OUTRIGGERS



Install left outrigger **20** on the front weight mount bracket using six 5/8" bolts **21** provided.

Install left outriggers **22** on the under tractor support bracket using six 5/8" bolts **23** provided.

Repeat for right outriggers.

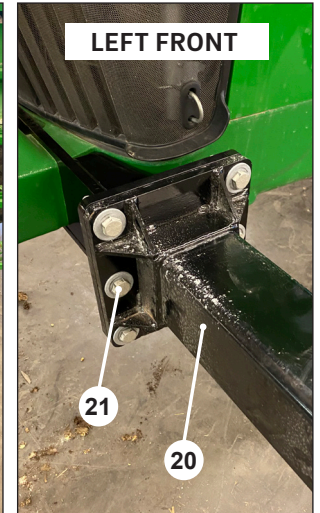

INSTALLATION INSTRUCTIONS

JOHN DEERE 8RT



STEP 8

FRONT UNDER TANK SUPPORT TUBES - LEFT

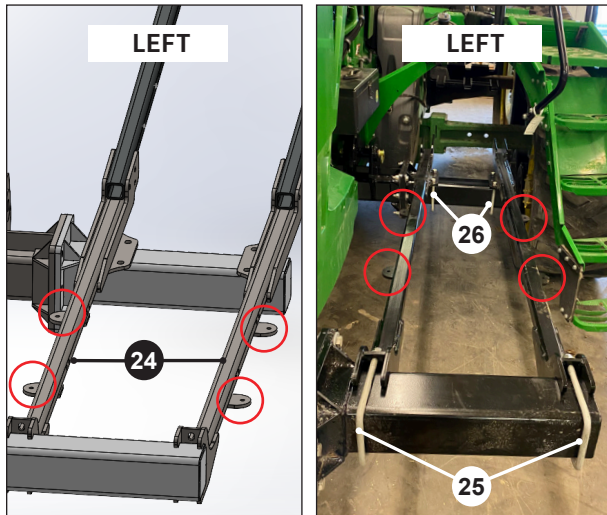

NOTE: Tube orientation is critical. The tube closest to the tractor should have the welded tabs oriented towards the tractor. The tube furthest from the tractor should have the welded tabs oriented away from the tractor.

Locate hardware kit 502051.

On the left side of the tractor install the front under tank support tubes ²⁴, paying close attention to the orientation of the welded tabs (circled above) on each tube.

Secure the front of each tube to the front outrigger with a u-bolt ²⁵, oriented as shown in the picture above.

Secure the back of each tube to the middle outrigger with a u-bolt ²⁶ oriented with the nuts on top.

Repeat this process for the two front under tank support tubes on the right side of the tractor.

STEP 9

FRONT UNDER TANK SUPPORT TUBES - RIGHT

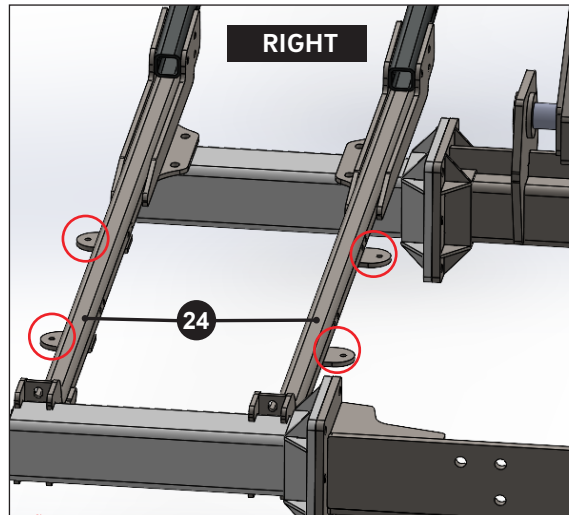

Repeat step 8 for the two front under tank support tubes on the right side of the tractor.

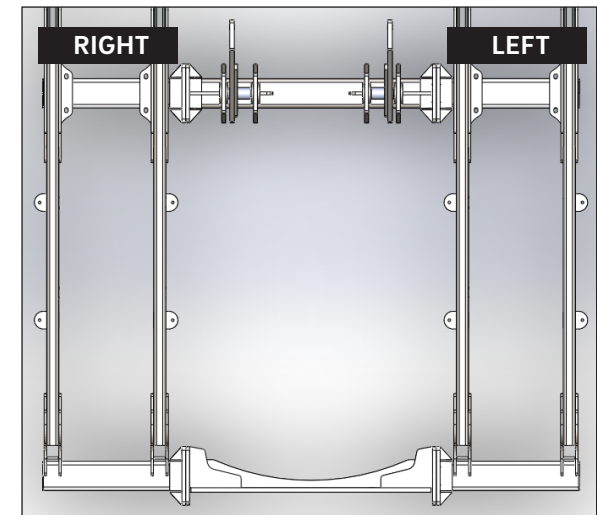

The picture above shows all four front under tank support tubes installed.

INSTALLATION INSTRUCTIONS

JOHN DEERE 8RT

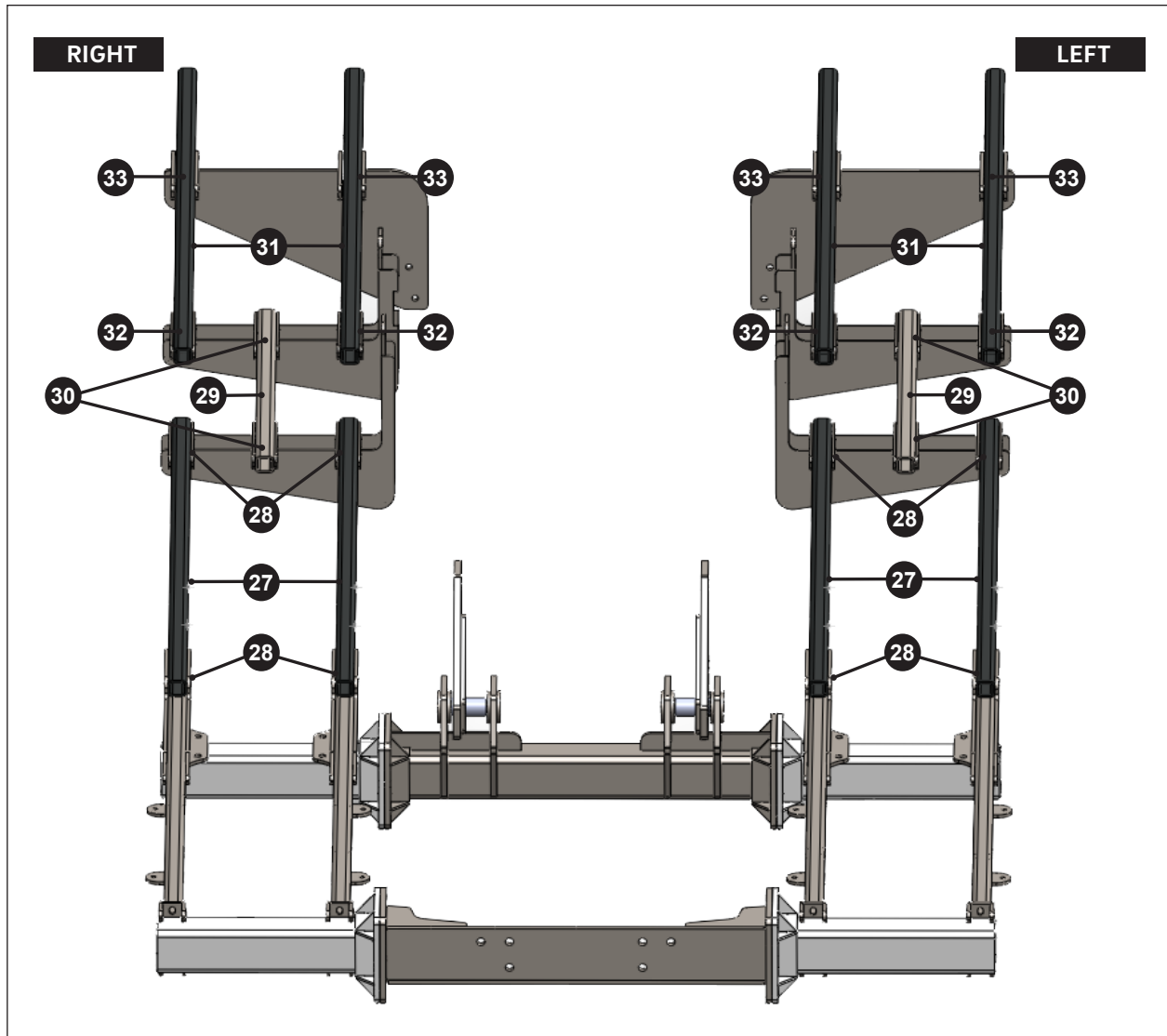

Hardware Kit 502052 will be used for Steps 10 and 11.

STEP 10

MIDDLE UNDER TANK SUPPORT TUBES

Install the two middle under tank support tubes (Part # 502419) ²⁷ between the front under tank support tubes and the first under tank support bracket.

Secure the front and back of the middle support tubes with 3-1/2" x 3/8" bolts ²⁸.

Repeat for both sides of tractor.

STEP 11

BACK UNDER TANKS SUPPORT TUBES

Set the shortest 2x2 under tank support tube (Part Number 502408) ²⁹ between the first and second under tank support brackets. Secure to the brackets using four 3-1/2" x 3/8" bolts ³⁰.

Set the two rear under tank support tubes (Part Number 502418) ³¹ in the mounts previously installed.

Secure the front of each tube to the second under tank support bracket using four 3-1/2" x 3/8" bolts ³².

Secure the back of each tube to the rear under tank support bracket using four 3-1/2" x 3/8" bolts ³³.

Repeat on the opposite side of the tractor.

INSTALLATION INSTRUCTIONS

JOHN DEERE 8RT

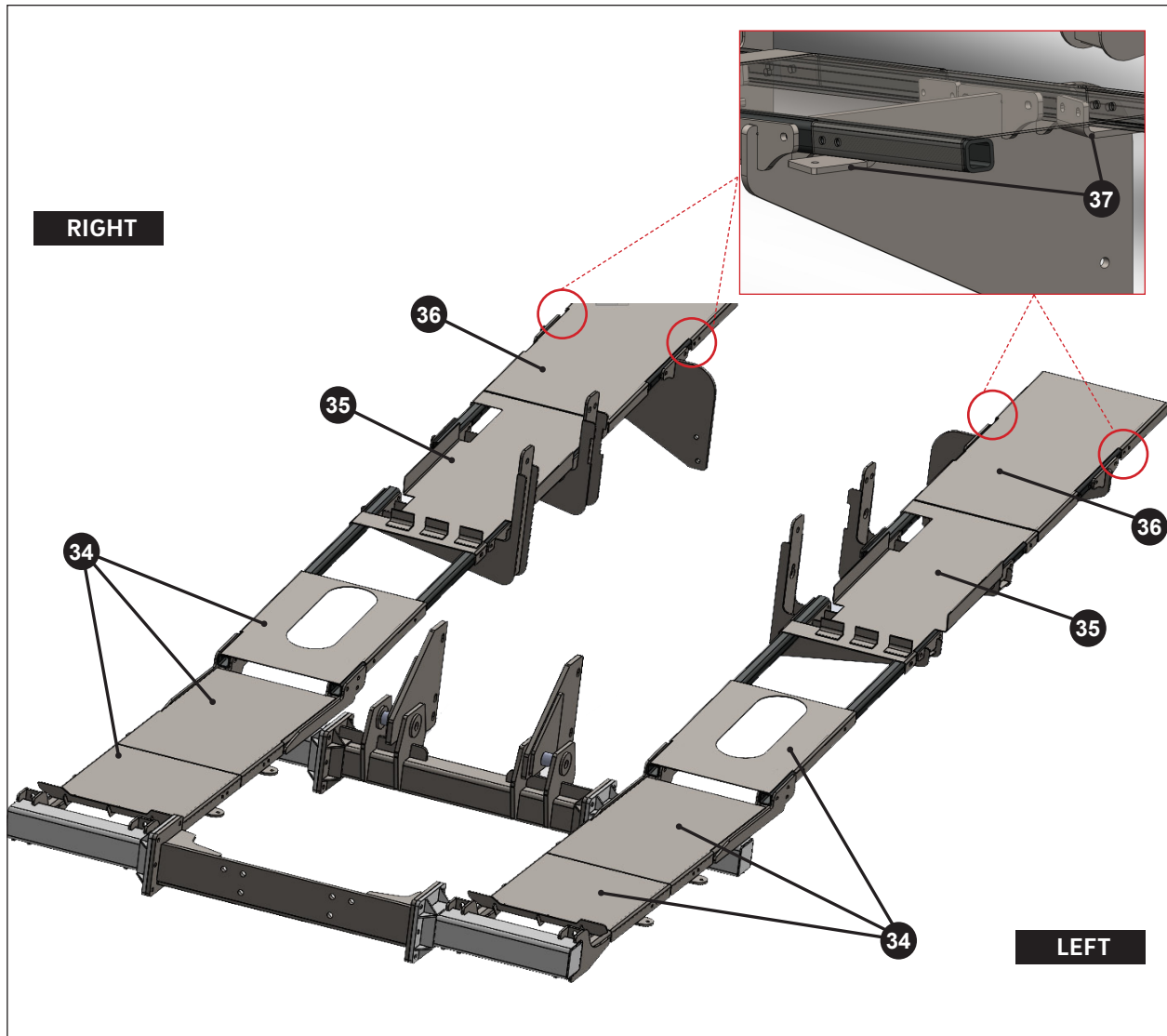

Hardware Kit 502055 will be used for Steps 12 and 13.

STEP 12

UNDER TANK SUPPORT PANS - FRONT

Set the first three under tank pans **34** across the front and middle under tank support tubes. Orient as seen in the picture. Secure the sides of the pans to the under tank support tubes using the 3" x 3/8" bolts.

Repeat for both sides of tractor.

STEP 13

UNDER TANK SUPPORT PANS - BACK

Set the two under tank pans for the back tank **35** and **36** on the under tank support tubes. Orient as seen in the picture. Secure pan **35** to the tubes using 3" x 3/8" bolts.

For pan **36**, insert the 3-1/2" x 3/8" bolt through the pan and tube. Before securing the bolts with washers and nuts, slide the "L" bracket (Part Number 502637) **37** onto the bolts. With the "L" brackets installed on both sides, finish securing the bolts with washers and nuts.

Repeat on opposite side of tractor.

INSTALLATION INSTRUCTIONS

JOHN DEERE 8RT



LEFT

RIGHT

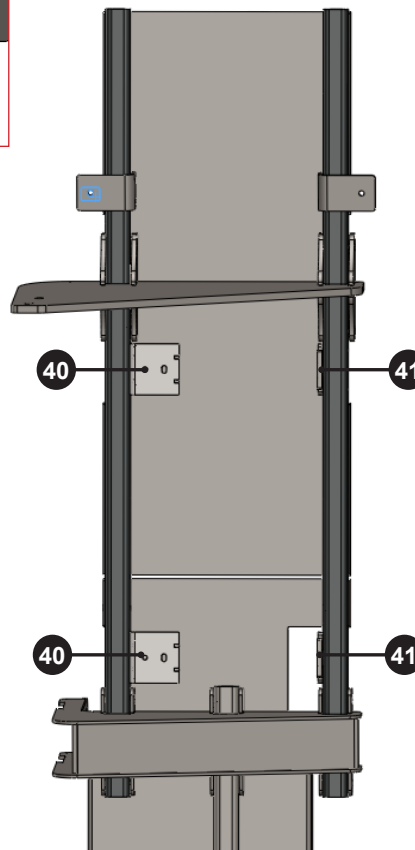
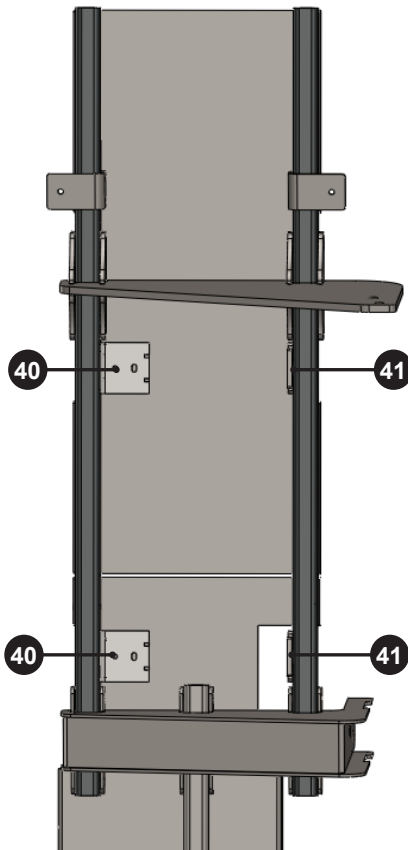
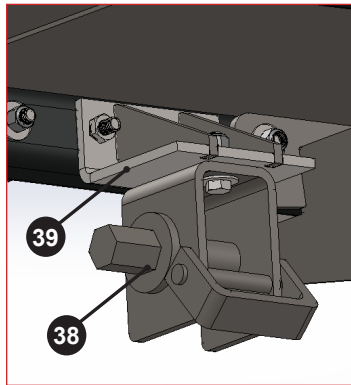

Hardware Kit 502056 will be used for Step 14.

STEP 14

RATCHET ASSEMBLIES

Attach each ratchet **38** to a ratchet bracket (Part Number 502635) **39** using 3/8" bolts. There should be four ratchet assemblies in total.

On the left side of the tractor, install two of the ratchet assemblies to the outer under tank support tube **40**. Secure to the tube using 3" x 3/8" bolts.

Directly across from each mounted ratchet assembly, secure a flat plate (Part Number 502638) **41** with 3" x 3/8" bolts.

Repeat on the right side of the tractor.

INSTALLATION INSTRUCTIONS

JOHN DEERE 8RT



STEP 15

FRONT SIGHT GAUGES

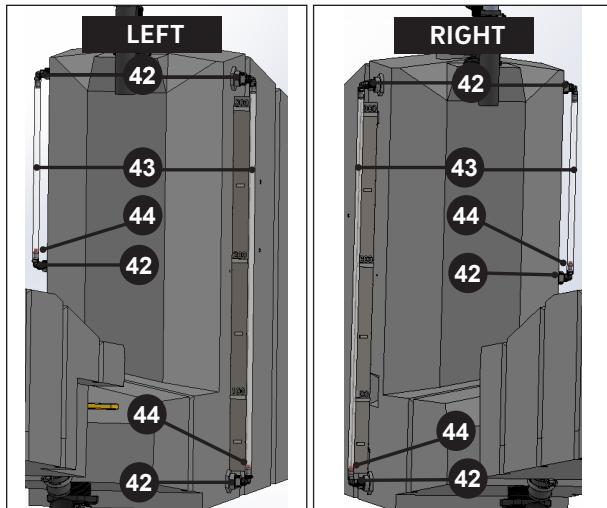

For both front tanks, apply white thread sealing tape to threads on each of the elbow hose fittings.

Screw elbows **42** into the 1/4" NPT fittings at the inside and outside of the tank. Orient towards each other.

Install clear tube **43** between elbows, securing each end of the hose to the elbow with worm gear hose clamp. **Ensure to insert red float ball 44 inside tube before securing both ends.**

NOTE: Use lubricant as needed to slide hose onto fittings.

STEP 15 CONTINUED...

BACK SIGHT GAUGES

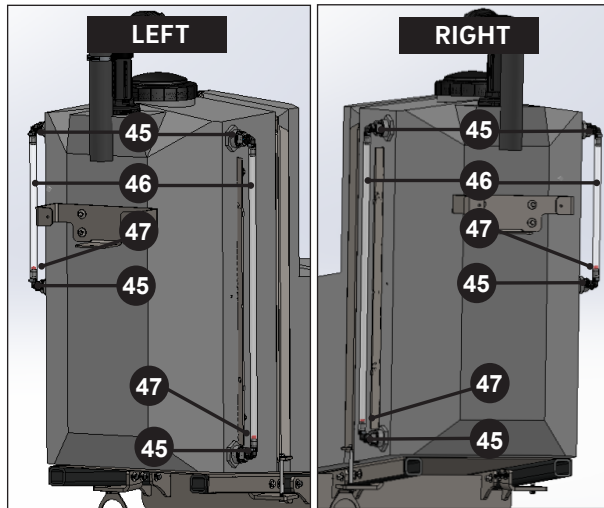

For both back tanks, apply white thread sealing tape to threads on each of the elbow hose fittings.

Screw elbows **45** into the 1/4" NPT fittings at the inside and outside of the tank. Orient towards each other.

Install clear tube **46** between elbows, securing each end of the hose to the elbow with worm gear hose clamp. **Ensure to insert red float ball 47 inside tube before securing both ends.**

NOTE: Use lubricant as needed to slide hose onto fittings.

STEP 16

MEASUREMENT GUIDE

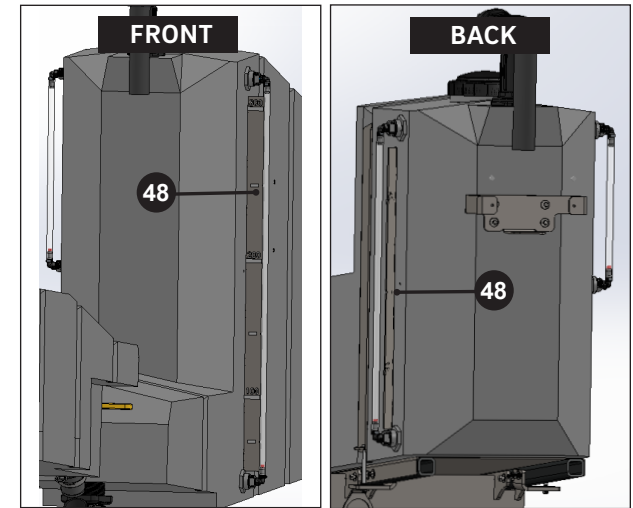

Install the measurement guide **48** along the longer sight gauge on each tank and orient it so you can see the values from the tractor. Secure to each tank using 3/4"x 1/4" bolts.

INSTALLATION INSTRUCTIONS

JOHN DEERE 8RT

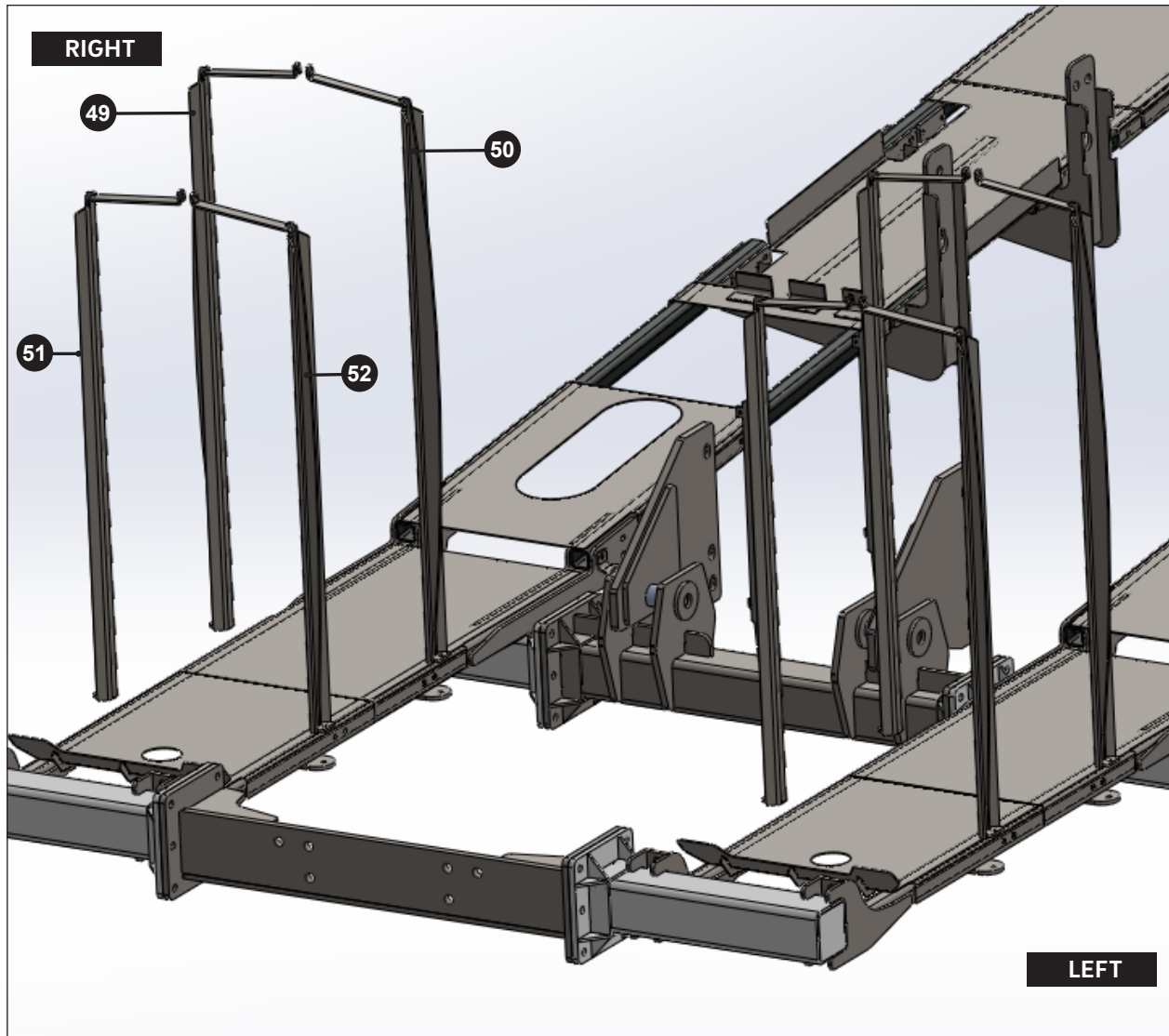

All tanks are left/right specific. The longer sight tube on each tank goes towards the tractor.

STEP 17

FRONT RIGHT TANK

On the right side of the tractor, slide the front right tank onto the pans. When in place, the grooves on the tanks should align with the tabs on the under tank support tubes.

The tanks are secured to the under tank supports with steel straps.

NOTE: To allow you to see each strap, tanks have been removed from the picture but they should be sitting on the under tank supports before installing the steel straps.

Locate the following steel straps by part number:

502010 49

502011 50

502012 51

502013 52

Secure the front right tank to the under tank support tubes with the steel straps as oriented in the picture using hardware provided in hardware kit #502057.

The shorter 3/8" bolt will connect the two straps at the top and the longer bolts will secure the straps to the under tank supports.

INSTALLATION INSTRUCTIONS

JOHN DEERE 8RT

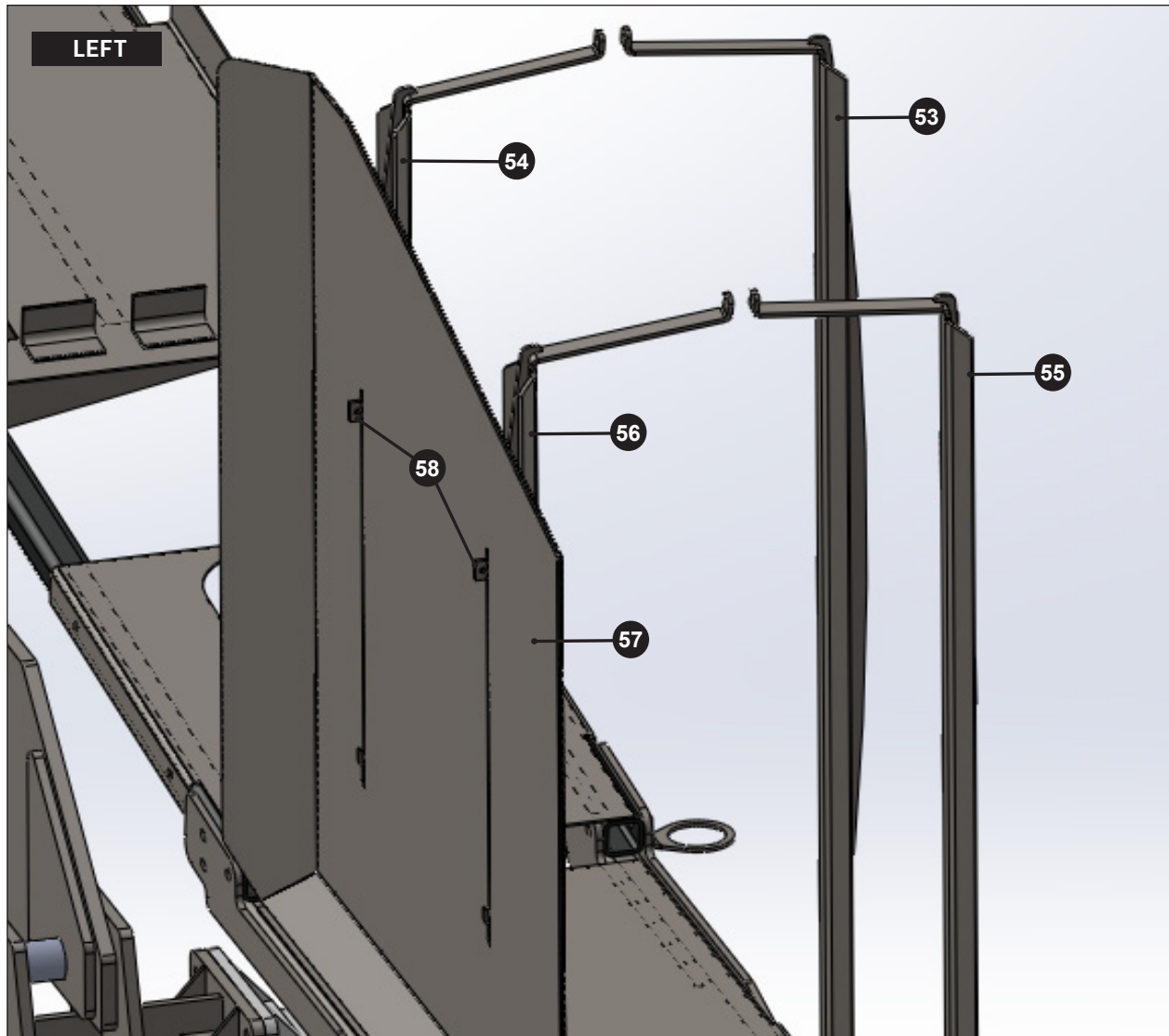

All tanks are left/right specific. The longer sight tube on each tank goes towards the tractor.

STEP 18

FRONT LEFT TANK

On the left side of the tractor, slide the front right tank onto the pans. When in place, the grooves on the tanks should align with the tabs on the under tank support tubes.

The tanks are secured to the under tank supports with steel straps.

NOTE: To allow you to see each strap, tanks have been removed from the picture but they should be sitting on the under tank supports before installing the steel straps.

Locate the following steel straps by part number:

502011 **53**

502026 **54**

502013 **55**

502025 **56**

Secure the front right tank to the under tank support tubes with the steel straps as oriented in the picture using hardware provided in hardware kit #502057.

The shorter 3/8" bolt will connect the two straps at the top and the longer bolts will secure the straps to the under tank supports.

Install heat shield **57** between the front left tank and tractor using the 1/4" lockpins **58** to attach the shield to the steel straps.

INSTALLATION INSTRUCTIONS

JOHN DEERE 8RT

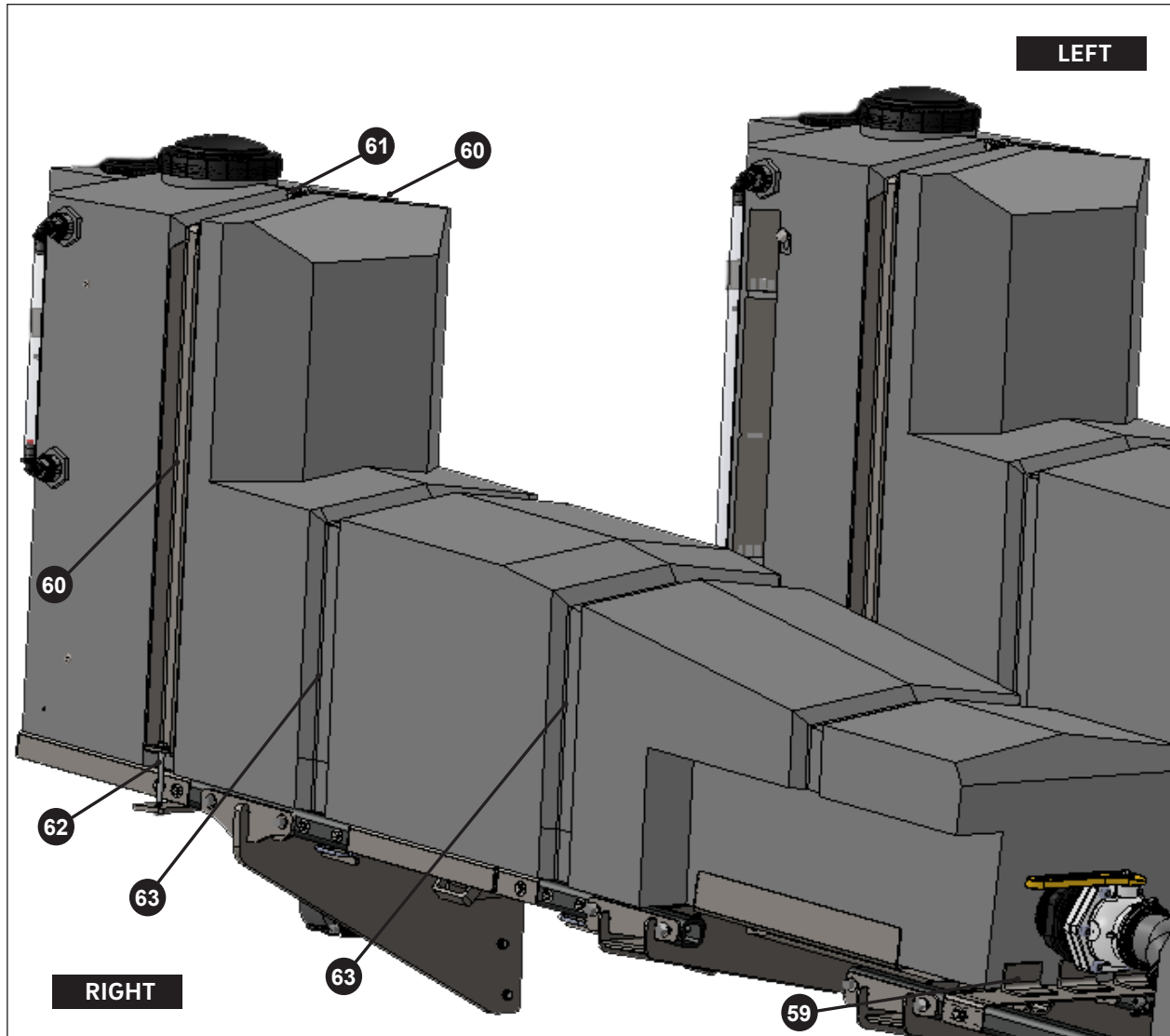

All tanks are left/right specific. The longer sight tube on each tank goes towards the tractor.

STEP 19

BACK TANKS

On the right side of the tractor slide the back right tank onto the pans from the rear of tractor. Ensure the tank slides all the way to the tank stops **59** at the front of the pan.

Locate two of the steel straps labeled with part number 502014 **60**. Place the straps across the rear rib and connect with the shorter 3/8" bolt **61**.

Secure the bottom of the straps to the under tank support tube using 7" x 3/8" bolts **62**.

Set the nylon straps across the two middle ribs of the back tank **63**, connect to the previously installed ratchet assemblies and ratchet tight.

Excess nylon strap can be cut to desired length.

Repeat on the left side of the tractor.

INSTALLATION INSTRUCTIONS

JOHN DEERE 8RT



STEP 20

LIGHT BRACKET

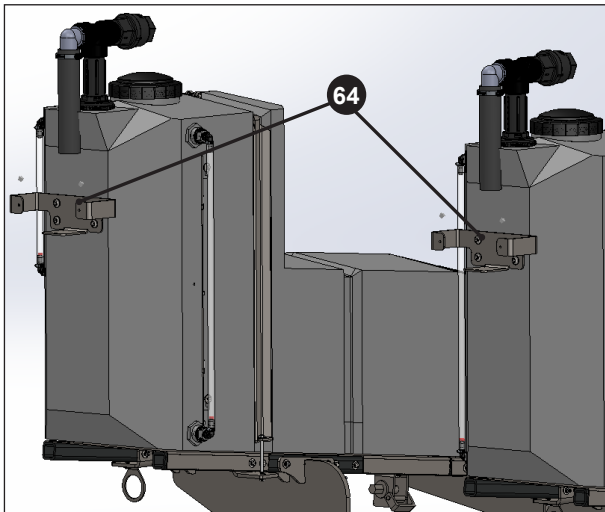

At the rear of both the back tanks, install the light brackets **64** using 3/4" x 1/4" bolts.

Install taillights and flood light on the light brackets using the extension harness provided and the original hardware from when the lights were removed.

NOTE: When reinstalling the taillights the orange light should be on the top and the red light on the bottom.

STEP 21

VENTS

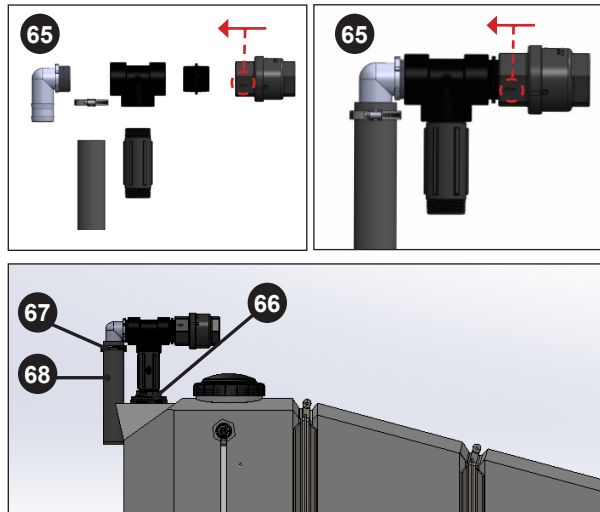

Complete the vent assembly as pictured above for each of the four tanks **65**.

NOTE: Ensure the arrow on the check valve is oriented as shown in the diagram above.

Install each vent assembly to the top of each tank **66**.

Slide a hose clamp **67** over the elbow of the vent assembly. Slide the 2" hose **68** onto the elbow and secure by tightening the hose clamp. Route the hose as you see fit and cut to desired length.

Repeat for each vent assembly.

STANDARD LINES KIT

JOHN DEERE 8RT



STEP 22

STANDARD LINES KIT (PART #502509)

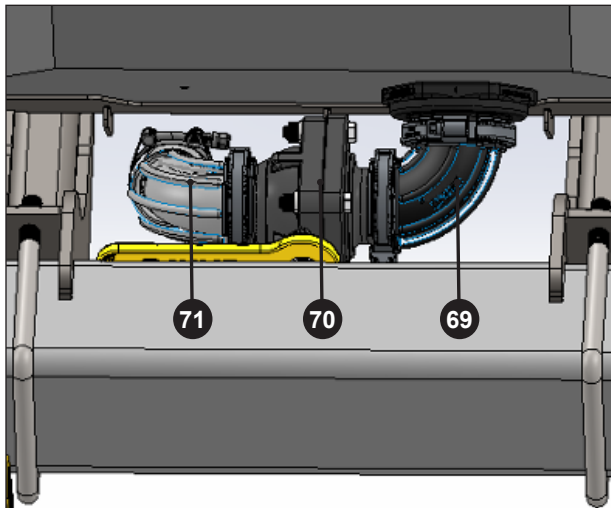

At the front of the front right tank, install elbow 69 into tank bulkhead using rubber seal and clamp.

Install 2" valve 70 to elbow and secure using rubber seal and clamp. Orient handle as desired.

Install flange elbow 71 to the valve and secure using rubber seal and clamp.

Repeat for front left tank.

STEP 23

CONNECT FRONT & BACK TANKS

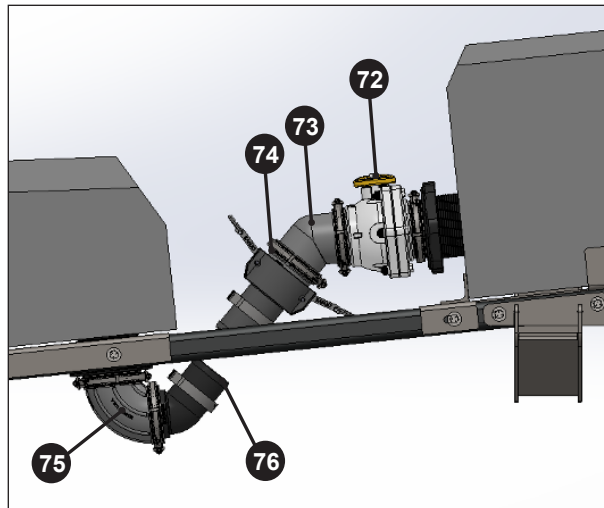

Thread the 3" valve 72 in to the back tank using thread sealant.

Connect the 45 degree fitting 73 to the valve using hose clamps with rubber seals.

Install male camlock to the 45 degree fitting 74.

On the front tank, install the sweep 90 degree fitting 75.

Put together 10" hose with 45 degree barb and female camlock 76 and install between sweep 90 and male camlock 74. Repeat for opposite side.

STEP 23

CONTINUED...

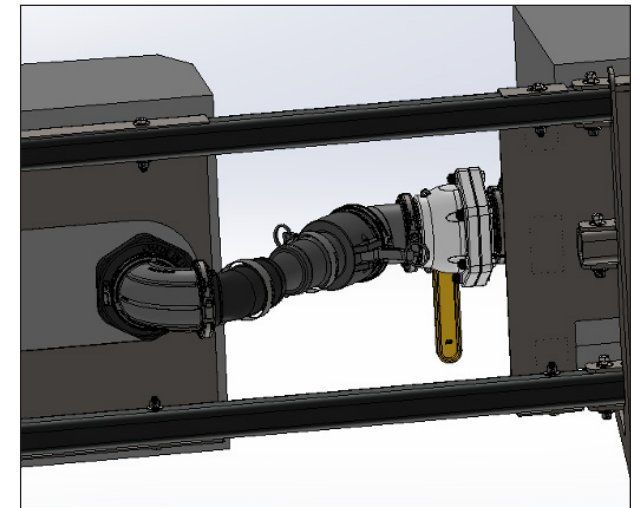

The complete plumbing connection between the front and back tank should look like the picture above.

NOTE: this picture is from the bottom of the tractor.

STANDARD LINES KITS COMPLETE

OPTIONAL LINES KIT

JOHN DEERE 8RT



STEP 24

OPTIONAL LINES KIT (PART #502518)

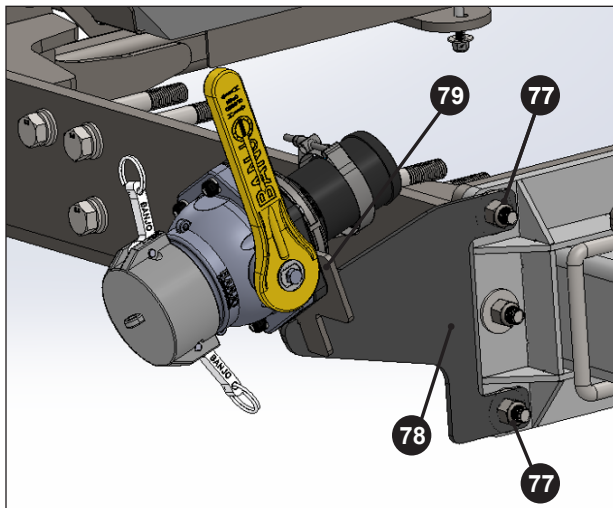

At the front left outrigger, remove the top and bottom bolts **77**.

Install the front valve bracket **78** and secure by reinstalling the two bolts previously removed **77**.

Remove three bolts from the bottom of the 3" valve and use them to attach the valve to the front valve bracket **79**.

STEP 25

FOUR-WAY CROSS

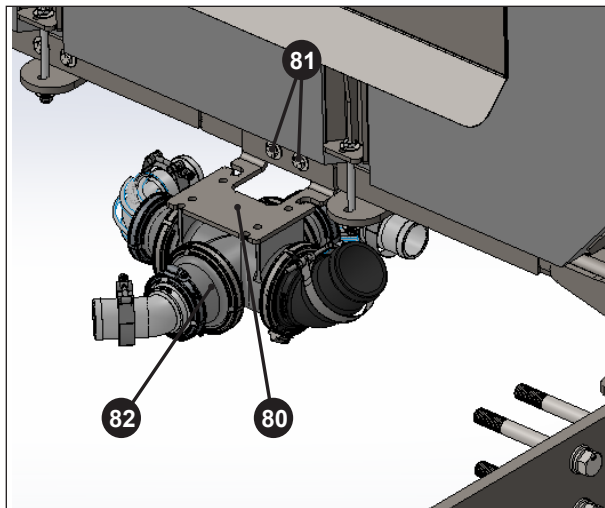

Locate the cross plumbing bracket (Part #502019) **80**.

Install bracket under the front left tank, on the inside of the rail towards the tractor. To secure to the under tank mount tube, remove the bolts from the pan and reinstall through the bracket **81**.

Locate the four-way cross plumbing assembly **82**.

Using zip ties, secure the four-way cross assembly to the bracket. Flexibility will be helpful when routing hoses.

STEP 26

CONNECT FRONT TO FOUR-WAY CROSS

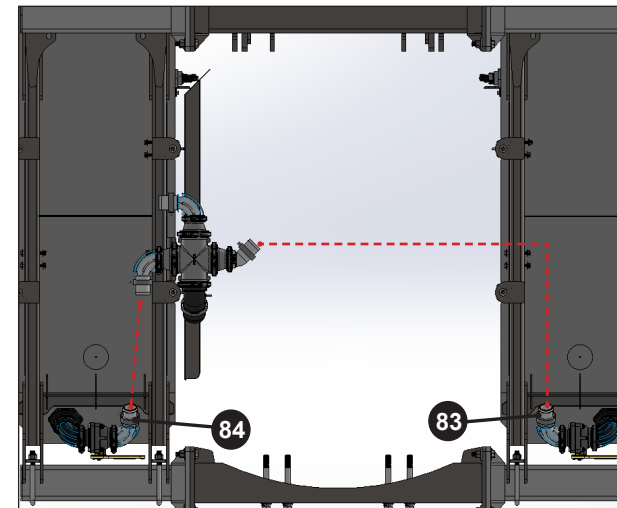

NOTE: The hose for the followings steps is not pre-cut. You will need to cut to desired length for your specific use.

Connect the 2" valves from both the front right **83** and front left tanks **84** to the four-way cross plumbing assembly as pictured above.

PLUMBING INSTRUCTIONS

JOHN DEERE 8RT



STEP 27

INSTALL SHUT-OFF VALVE

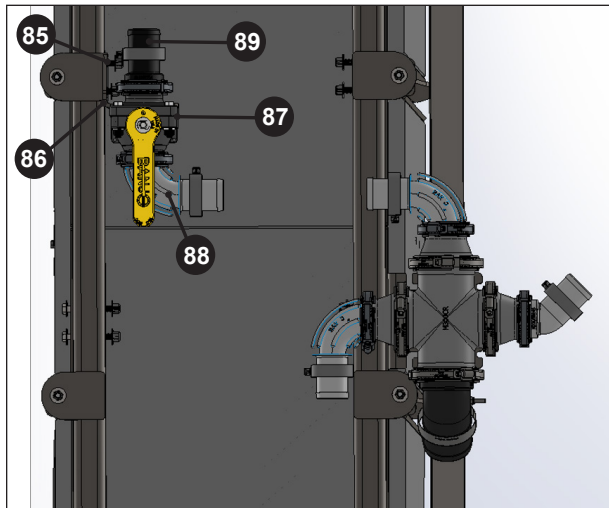

Using the bolts for the middle pan for the the front left tank **85** install the bracket (Part #502021) **86** to hold a 2" valve **87**.

Remove two bolts from the bottom of the valve and reuse bolts to attach valve to the bracket.

Using hose clamps and rubber gaskets, attach the sweep 90 **88** to the valve, followed by a straight barb on the other side **89**.

STEP 28

ROUTE REMAINING PLUMBING

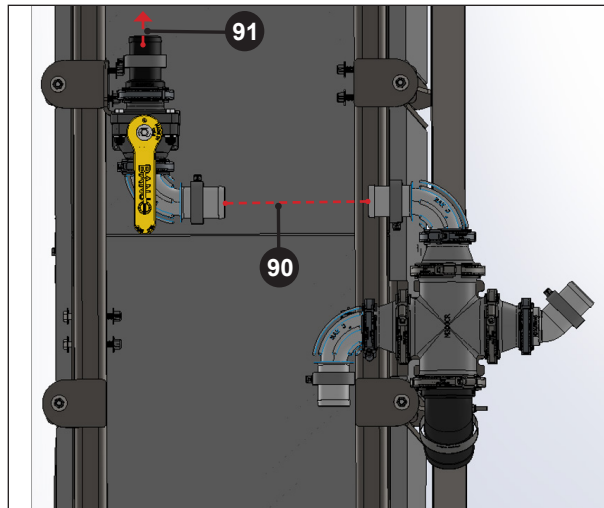

Connect this 2" valve assembly to the four-way cross plumbing assembly with 2" hose **90**.

Attach remaining 2" hose to the other side of the 2" valve **91** and route to desired location.

INSTALLTION COMPLETE

OPTIONAL LINES KIT

