



# 360 WAVE™

INSTALLATION INSTRUCTIONS  
KINZE MODELS  
WITHOUT 360 BANDIT



[360YIELDCENTER.COM](http://360YIELDCENTER.COM)

FOR QUESTIONS PLEASE CONTACT OUR  
PRODUCT SUPPORT TEAM AT 309-300-3120

3.20.23 • V4

All trademarks are the property of 360 Yield Center, its affiliates and/or its licensors. ©2020 360 Yield Center. All rights reserved.

# INSTALLATION INSTRUCTIONS

## KINZE MODELS WITHOUT BANDIT



### STEP 1

#### PREPARE THE ROW UNIT

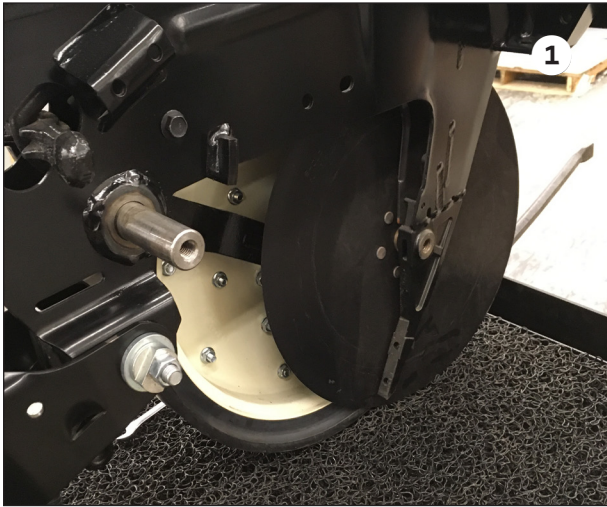

Remove both gauge wheels and the right-side opening disk ①.

### STEP 2

#### REMOVE CLOSING ASSEMBLY

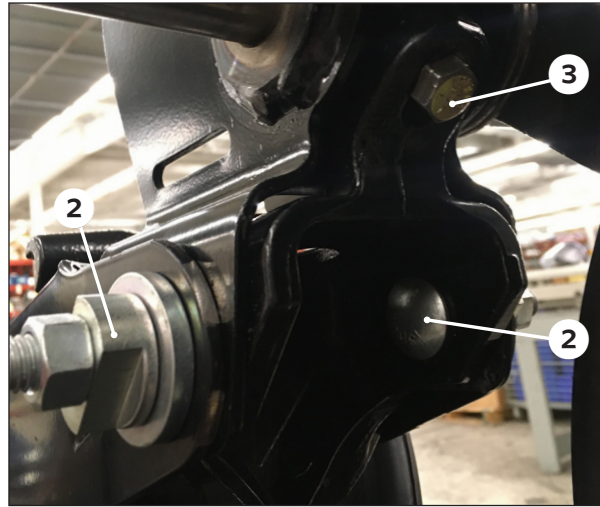

Remove the (2) carriage bolts ② and one regular bolt ③ that secure the closing casting to the row unit.

Save the two carriage bolts and nuts as they will be reused.

Remove the closing casting.

Unhook the closing spring and remove the closing assembly.

### STEP 3

#### INSTALL NEW CLOSING CASTING

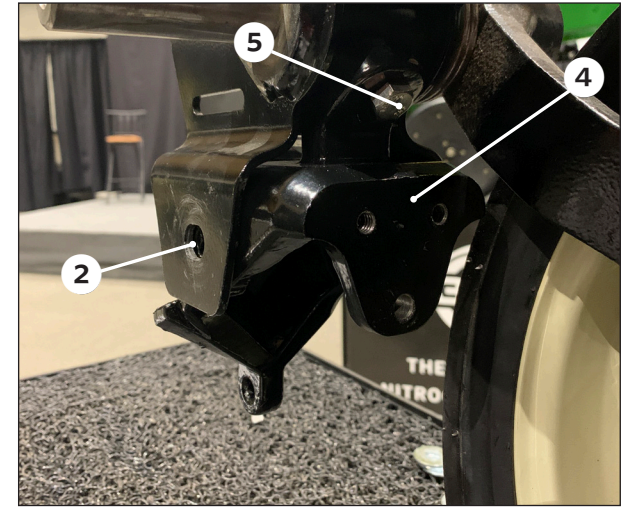

Install the provided closing casting ④ securing the top mounting location first using the provided 3/8" bolt ⑤.

Then, using the previously removed carriage bolts reinstall the closing assembly ②.

**NOTE: Ensure the front face of the new closing casting is vertical prior to tightening.**

Reinstall the closing system and secure with the previously removed nuts. Be sure to re-hook the closing spring.

# INSTALLATION INSTRUCTIONS

## KINZE MODELS WITHOUT BANDIT



### STEP 4

#### INSTALL WAVE ASSEMBLY

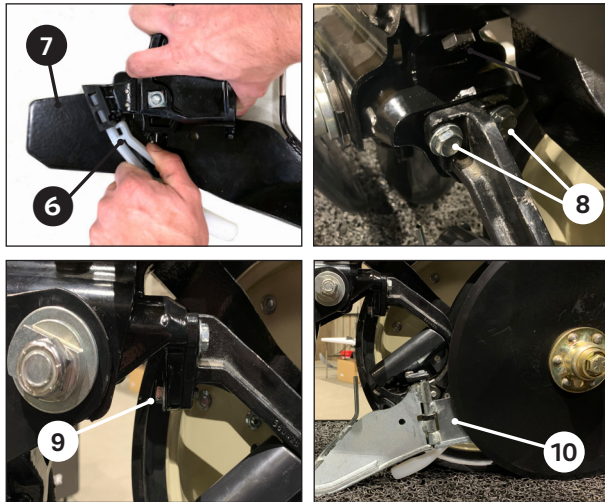

Install firm **6** on the wave assembly **7** by pinching the top of the firm together and slide it into place.

Install the WAVE assembly on the WAVE mounting bracket using the provided hardware. Two bolts will be inserted on the front **8** and one on the back **9** of the assembly.

**NOTE:** When installing the WAVE assembly ensure the blade residue guard is flush against the seed tube guard **10**.

### STEP 5

#### INSTALL PLUMBING

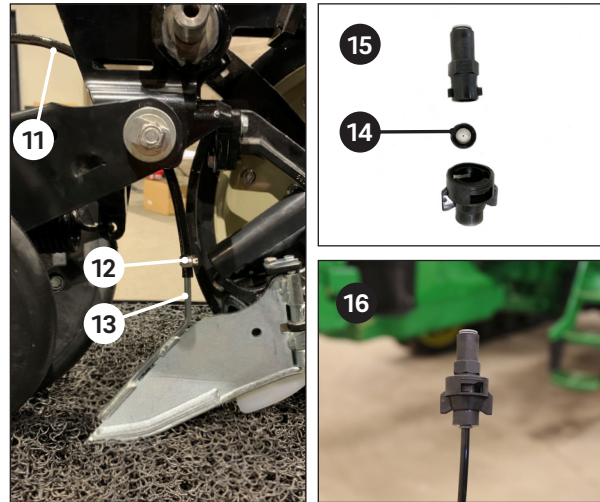

Route the 3/8" line through the hole on the row unit **11**.

Loosely place the hose clamp **12** onto the hose and install the hose over the product tube **13**. Slide clamp down over hose and product tube and tighten.

Assemble the orifice into the rubber grommet **14**.

Assemble the three plumbing components in the arrangement shown above **15**.

Attach the plumbing assembly to the other end of the 3/8" line **16**. Secure the line to the row unit using zip ties as you see fit.

### STEP 6

#### REINSTALL GAUGE WHEELS AND DISK

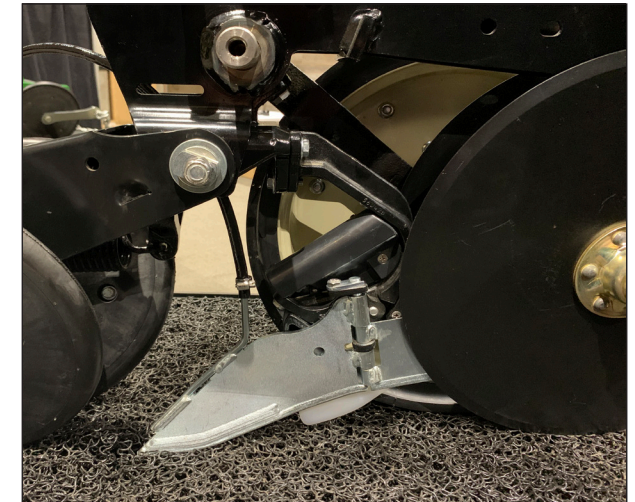

Reinstall right side disk and both gauge wheels using original hardware.

**NOTE:** Contact between the WAVE residue guard, and the inside of the right hand opening disk is normal. Adjust opening disks to OEM specs for best performance.

**NOTE:** When the planter is raised, contact between the WAVE blade and large spiked closing wheels is normal. During operation, the closing system comes up to operating depth and proper clearance is achieved.

#### INSTALLATION COMPLETE

**NOTE:** Backing up when planter is not raised can cause wave blade to catch in the ground and bend or break. Use care to only back up after planter row unit is disengaged from the ground.